

Arrays/Dual Diodes

RCA Type	Material	Description	Peak Reverse Voltage (PRV) V_{RRM} V	Forward Current I_{FAV} A	Reverse Current I_R μ A	Outline No.
SK3110/120	Se	Convergence Array	35	0.065	300	R-021
SK9001/113A	Si	Dual Diode, Common Cathode	200	1.5	5	R-030
SK9002	Si	Dual Diode, Common Anode	200	1.5	5	R-030
SK9296	Si	Dual Diode, Series Connected	100	1	10	R-019
SK7332/582	Si	TV Damper Tube Replacement	6000	0.3	5	R-069

Silicon Stick Rectifier

SK3443/513	$V_{RRM}=45,000V$	Forward Voltage Drop $V_{FM}=120V$ at $I_F=10mA$	$I_R=1 \mu A$	$T_A=90^\circ C$	R-031
------------	-------------------	--	---------------	------------------	-------

Silicon PIN Diode

RCA Type	LIMIT CONDITIONS		CHARACTERISTICS (All Values Maximum)					Case Style	Outline No.
	Fwd. Power Dissipation P_D mW	Reverse Voltage V_{RRM} V	Reverse Current I_R μ A	Series Resistance R_S Ω	Diode Capacitance C_T pF	Test Conditions			
						Reverse Voltage V_R V	Frequency f MHz		
SK9150A/555	250	35	0.05	0.7	1	15	1	—	R-057A

Dimensional Outlines and Terminal Diagrams

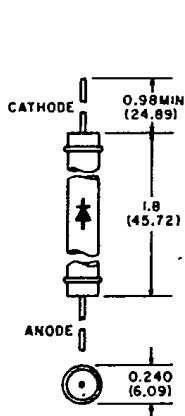

R-009

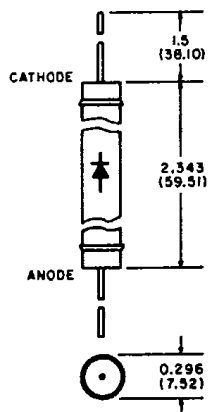

R-010

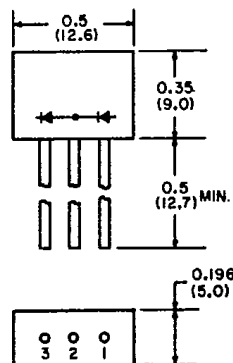

R-019

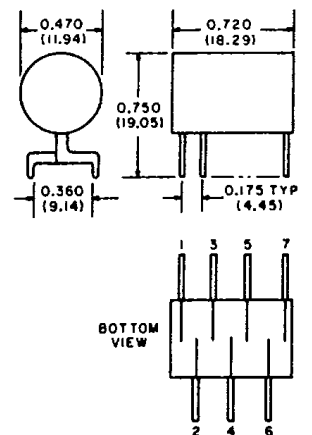

R-021

Dimensional Outlines and Terminal Diagrams

www.DataSheet4U.com

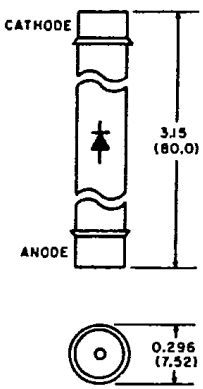

R-024

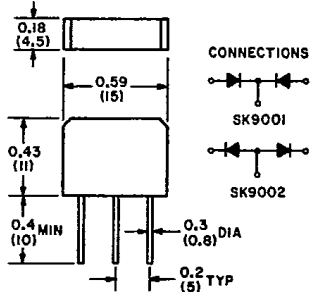

R-030

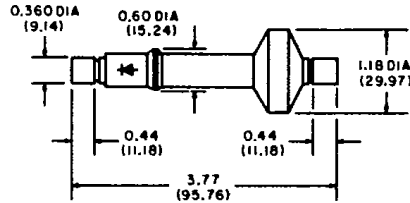

R-031

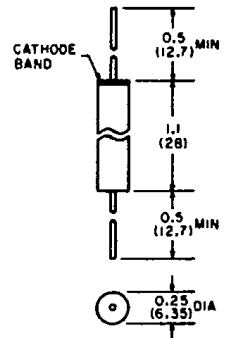

R-054

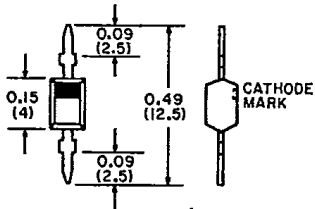

R-057A

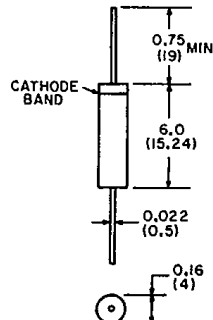

R-067

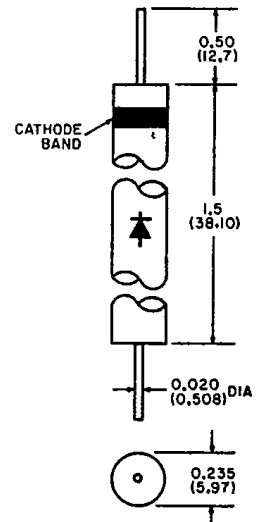

R-068

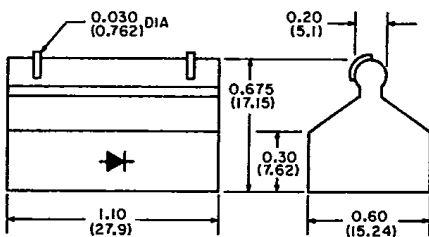

R-069

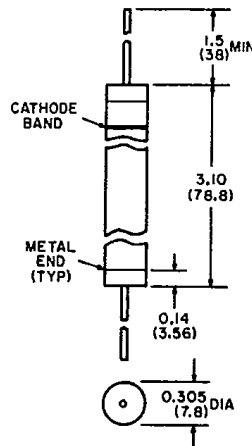

R-085

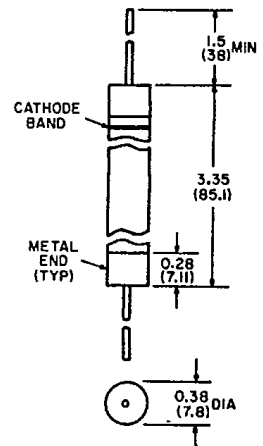

R-086

Dimensions in inches (millimeters).
All dimensions are max. unless otherwise indicated.

www.DataSheet4U.com