

2

1

REVISION HISTORY			
REV	AUTH	DATE	DESCRIPTION
A	-	5/28/2008	INITIAL RELEASE

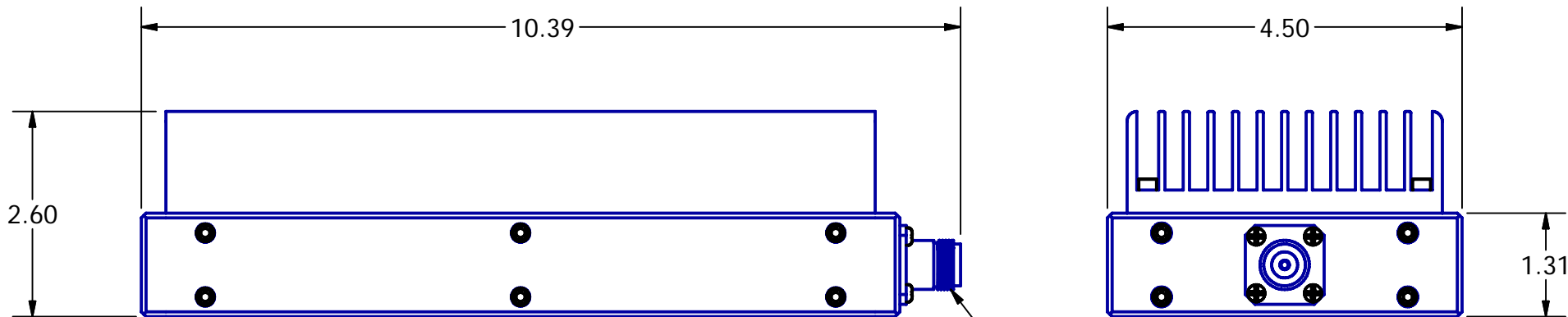

TYPE-N FEMALE CONNECTOR

POWER RATING: 500 WATTS

FREQUENCY (Ghz)	VSWR			Model #
2.0 - 4.2	2.0 - 2.4 1.5:1	2.4 - 3.0 1.45:1	3.0 - 4.2 1.30:1	T50024
2.0 - 8.0	2.0 - 2.4 1.5:1	2.4 - 3.0 1.45:1	3.0 - 8.0 1.30:1	T50024F
3.7 - 8.4	1.30:1			T50025
2.0 - 12.4	2.0 - 2.4 1.5:1	2.4 - 3.0 1.45:1	3.0 - 12.4 1.30:1	T50024G
3.0 - 12.4	1.30:1			T50025G

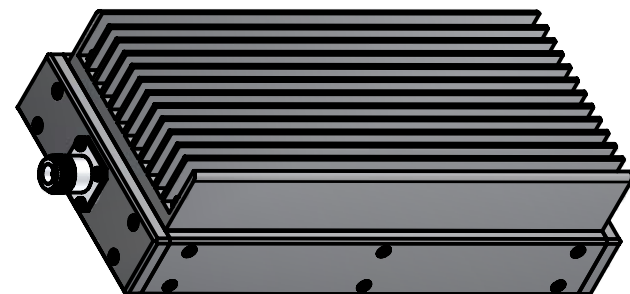

FINISH: BLACK ANODIZE OR HIGH TEMP BLACK PAINT

THIRD ANGLE PROJECTION:		APPROVALS	DATE	ADVANCED TECHNICAL MATERIALS, INC. TEL: (631) 289-0363 FAX: (631) 289-0358 www.atmmicrowave.com	<small>THE INFORMATION IN THIS DRAWING IS PROPRIETARY AND SHALL NOT BE USED OR DISCLOSED WITHOUT THE PRIOR WRITTEN CONSENT OF ATM, INC. DO NOT SCALE DWG.</small>																			
UNLESS OTHERWISE NOTED, DIMENSIONS ARE IN INCHES, TOLERANCES ARE: FRACTIONS: ±1/64 ANGLES: ±1/2°		DRAWN BF	5/28/2008		<h2 style="text-align: center;">OUTLINE, COAX TERMINATION</h2>																			
<table border="1"> <thead> <tr> <th>BASIC DIMENSION</th> <th>DECIMALS 2 PLACE</th> <th>DECIMALS 3 PLACE</th> </tr> </thead> <tbody> <tr> <td>UNDER 6"</td> <td>±.02</td> <td>±.005</td> </tr> <tr> <td>6" - 12"</td> <td>±.03</td> <td>±.010</td> </tr> <tr> <td>OVER 12"</td> <td>±.06</td> <td>±.015</td> </tr> </tbody> </table>		BASIC DIMENSION	DECIMALS 2 PLACE	DECIMALS 3 PLACE				UNDER 6"	±.02	±.005	6" - 12"	±.03	±.010	OVER 12"	±.06	±.015	CHKD. MR	5/28/2008	<table border="1"> <tr> <td>SIZE</td> <td>CAGE CODE</td> <td>ATM DWG #</td> <td>REVISION</td> </tr> <tr> <td>A</td> <td>0R8N4</td> <td>8799</td> <td>A</td> </tr> </table>	SIZE	CAGE CODE	ATM DWG #	REVISION	A
BASIC DIMENSION	DECIMALS 2 PLACE	DECIMALS 3 PLACE																						
UNDER 6"	±.02	±.005																						
6" - 12"	±.03	±.010																						
OVER 12"	±.06	±.015																						
SIZE	CAGE CODE	ATM DWG #	REVISION																					
A	0R8N4	8799	A																					
		APRVD. MB	5/28/2008	MODEL #	SEE NOTES	SHEET 1 OF 1																		
		MATERIAL AL ALY TYPE 6061-T6 BODY																						
		TREATMENT																						
		FINISH SEE NOTES																						

2

1