

**PLEASE CHECK WWW.MOLEX.COM FOR LATEST PART INFORMATION**

**Part Number:** [0471821001](#)  
**Status:** **Active**  
**Overview:** [battery connectors](#)  
**Description:** 2.00mm (.079") Pitch Battery Connector, SMT, Width 5.98mm (.235"), Working Height 2.10mm (.083"), 2 Circuits

**Documents:**

[3D Model](#) [Product Specification PS-47182-001 \(PDF\)](#)  
[Drawing \(PDF\)](#) [RoHS Certificate of Compliance \(PDF\)](#)

**General**

Product Family	PCB Headers
Series	<a href="#">47182</a>
Application	Board-to-Board
Overview	<a href="#">battery connectors</a>
Product Name	Battery Connector, Compression Connector, One Piece

**Physical**

Breakaway	No
Circuits (Loaded)	2
Circuits (maximum)	2
Durability (mating cycles max)	10,000
First Mate / Last Break	No
Glow-Wire Compliant	No
Guide to Mating Part	No
Keying to Mating Part	None
Lock to Mating Part	None
Mated Height (in)	0.083 In
Mated Height (mm)	2.10 mm
Material - Plating Mating	Gold
Material - Plating Termination	Gold
Number of Rows	1
Orientation	Vertical
PCB Locator	No
PCB Retention	None
Packaging Type	Embossed Tape on Reel
Pitch - Mating Interface (in)	0.079 In
Pitch - Mating Interface (mm)	2.00 mm
Plating min: Mating (µin)	30
Plating min: Mating (µm)	0.76
Polarized to Mating Part	No
Polarized to PCB	No
Shrouded	No
Stackable	No
Temperature Range - Operating	-40°C to +85°C
Termination Interface: Style	Surface Mount

**Electrical**

Current - Maximum per Contact	1A
Voltage - Maximum	200V

**Material Info**

**Reference - Drawing Numbers**

Packaging Specification	PK-47182-001
Product Specification	PS-47182-001
Sales Drawing	SD-47182-001

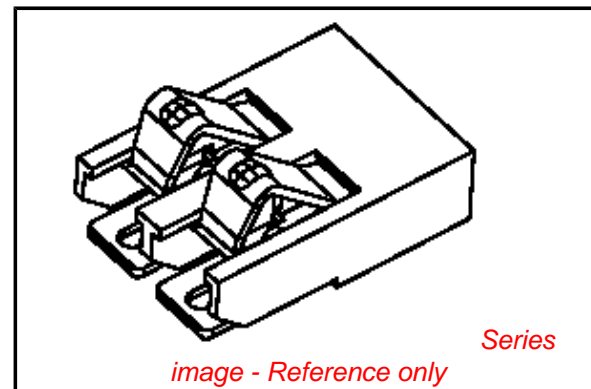

**EU RoHS**

**ELV and RoHS  
Compliant**  
**REACH SVHC**  
 Not Reviewed  
**Halogen-Free  
Status**

**China RoHS**



**Need more information on product  
environmental compliance?**

Email [productcompliance@molex.com](mailto:productcompliance@molex.com)  
 For a multiple part number RoHS Certificate of Compliance, [click here](#)

Please visit the [Contact Us](#) section for any non-product compliance questions.

**Search Parts in this Series**  
[47182Series](#)

This document was generated on 05/26/2010

**PLEASE CHECK [WWW.MOLEX.COM](http://WWW.MOLEX.COM) FOR LATEST PART INFORMATION**

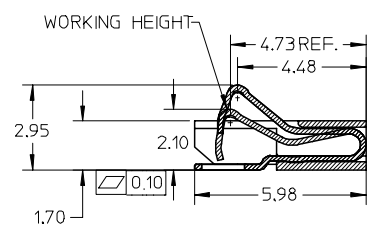
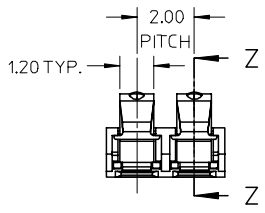
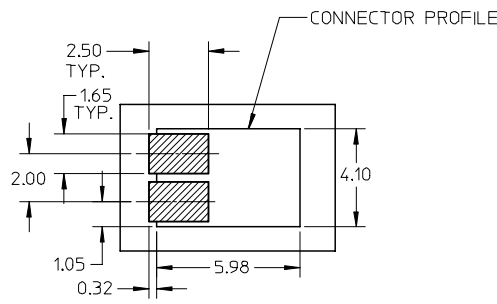
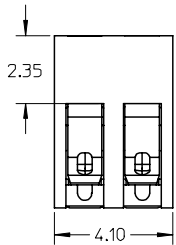
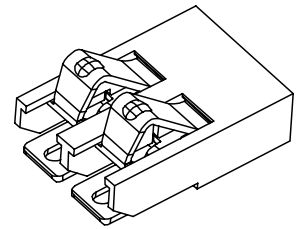

SECTION Z-Z

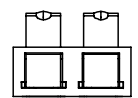
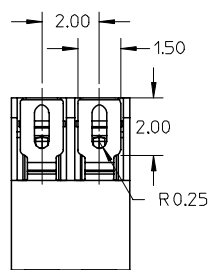

RECOMMENDED FOOT PRINT

- NOTE:
- MATERIAL:  
HOUSING: HIGH TEMPERATURE THERMOPLASTIC, COLOR :BLACK  
TERMINAL: COPPER ALLOY.
  - FINISH:  
CONTACT AREA: 0.75 MICRON GOLD MIN OVER 1.25 MICRON NICKEL MIN.  
SOLDER AREA: GOLD FLASH (0.075-0.125 MICRON) OVER 1.25 MICRON NICKEL MIN.  
REST AREA: 1.25 MICRON NICKEL MIN.
  - COPLANARITY: 0.1 MAX AMONG THESE SOLDER TAILS.
  - PRODUCT SPECIFICATION: PS-47182-001
  - WORKING HEIGHT: 2.10mm

REVISED EC NO: SH2007-0209 DRWN: LSHEN 2006/10/17 CHKD: 2006/10/18 APPR: JINCHEN 2006/10/20	QUALITY SYMBOLS DESCRIPTION	GENERAL TOLERANCES (UNLESS SPECIFIED)	SCALE 5:1	DESIGN UNITS METRIC	THIRD ANGLE PROJECTION	REVISE ON CAD ONLY		
		mm INCH	DIMENSION STYLE MM ONLY		TITLE			
		4 PLACES ± --- ± --- 3 PLACES ± --- ± --- 2 PLACES ± 0.15 ± --- 1 PLACE ± 0.20 ± ---	DRAWN BY LSHEN	DATE 2005/09/01	2.0MM PITCH 2 CIRCUITS BATTERY CONNECTOR			
		ANGULAR ± 2 °	CHECKED BY WU YAJUN	DATE 2005/09/04				
DRAFT WHERE APPLICABLE MUST REMAIN WITHIN DIMENSIONS	APPROVED BY VINCENT	DATE 2005/09/04	MATERIAL NO. 471821001	DOCUMENT NO. SD-47182-001	SHEET NO. 1 OF 1			
REV	DESCRIPTION	THIS DRAWING CONTAINS INFORMATION THAT IS PROPRIETARY TO MOLEX INCORPORATED AND SHOULD NOT BE USED WITHOUT WRITTEN PERMISSION					B	