

Type: M-7GLB, M-7GLM

Product Description

- 8.2 × 7.8mm Max.(L × W), 7.0mm Max. Height(M-7GLB).
- 8.2 × 7.8mm Max.(L × W), 6.5mm Max. Height(M-7GLM).
- Inductance:6.8mH Max.
- Operating frequency:1.0MHz Max.
- In addition to the reference versions of parameters shown here, custom designs are available to meet your exact requirements.

Feature

- High inductance variable type(M-7GLB) and fixed type(M-7GLM) are both available.
- RoHS Compliance

Dimensions (mm)



M-7GLB

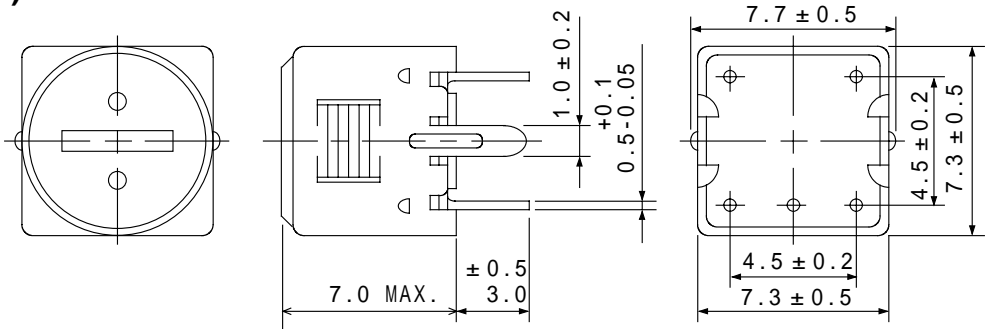

M-7GLM

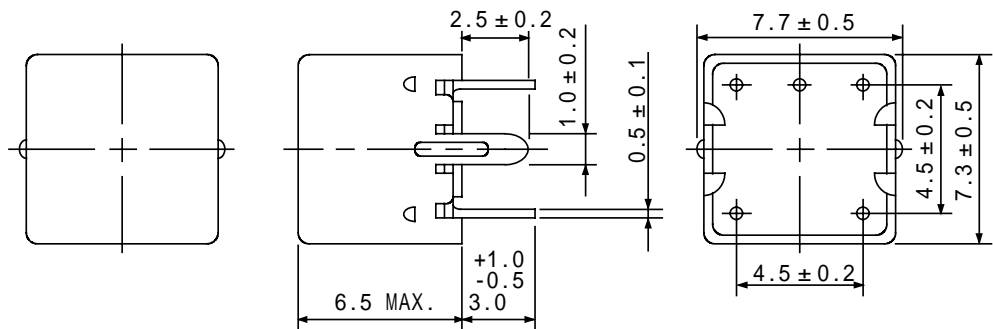

- * Dimension does not include solder used on coil.
- * Pin pitch shall be measured at the root of terminal.

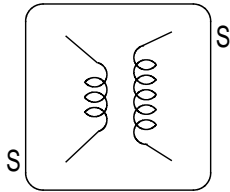
Type: M-7GLB, M-7GLM
Connection (Bottom View)
M-7GLB

"S" is winding start

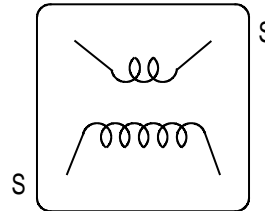
M-7GLM

"S" is winding start

Specification-(M-7GLB) (Part No. 4336-T012)

Item	Specification	Measuring Condition
Inductance (4-6)	1.5mH±5% Variable	1kHz
Inductance (1-3)	145µH (Ref)	1kHz
Unloaded Q (4-6)	27MIN (Ref)	100kHz

Specification-(M-7GLM) (Part No. 4338-T004)

Item	(1-6)	Measuring Condition
Inductance	72µH ± 40% Within	1kHz
Leakage Inductance	70µH (Ref.)	1kHz, (3-4) shorted