

ACP-4000MB

4U Rackmount Chassis for ATX Motherboard



Features

- Front-accessible USB and PS/2 keyboard connectors
- Visible LED indicators and audible alarm notification improves system availability and is easy to maintain
- Compatible with Dialogic computer telephony (CT) boards suitable for a wide range of call processing application
- Advanced cooling system with two system fans, optimally placed, to cool system's key components
- Shock-resistant disk drive bay holds three 5.25" and one 3.5" front-accessible disk drives
- Flexible mechanical design supports 300 W ATX PFC PS/2 power supply and 300 W ATX PFC redundant power supply



Specifications

Drive Bay	3.5"	Front-accessible	
	5.25"	1	3
Cooling	Fan	2 (85 CFM each)	
	Air Filter	Yes	
I/O Interface	USB	2 (Front-accessible)	
	PS/2	PS/2 keyboard and mouse, or PS/2 keyboard depends on the enclosed motherboard	
Miscellaneous	Slide Rail	General Device C-300 series supported (not included)	
Environment		Operating	Non-Operating
	Temperature	0 ~ 40 °C (32 ~ 104 °F)	-20 ~ 60 °C (-4 ~ 140 °F)
	Humidity	10 ~ 85 % @ 40 °C, non-condensing	10 ~ 95 % @ 40 °C, non-condensing
	Vibration (5-500 Hz)	1 Grms	2 G
	Shock	10 G (With 11 ms duration, half sine wave)	30 G
	Acoustic Noise	Less than 52 dB sound pressure at 5 ~ 28 °C (41 ~ 82 °F)	
Physical Characteristics	Altitude	0 to 3,048 m (0 ~ 10,000 ft)	
	Dimensions (W x H x D)	482 x 177 x 480 mm (19" x 7" x 18.9")	
	Weight	17.5 kg (38.5 lb)	

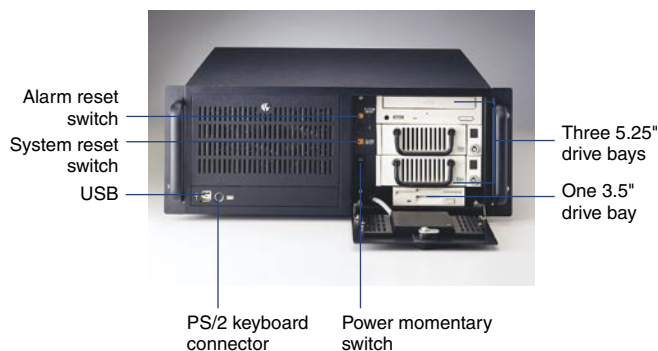

Dimensions

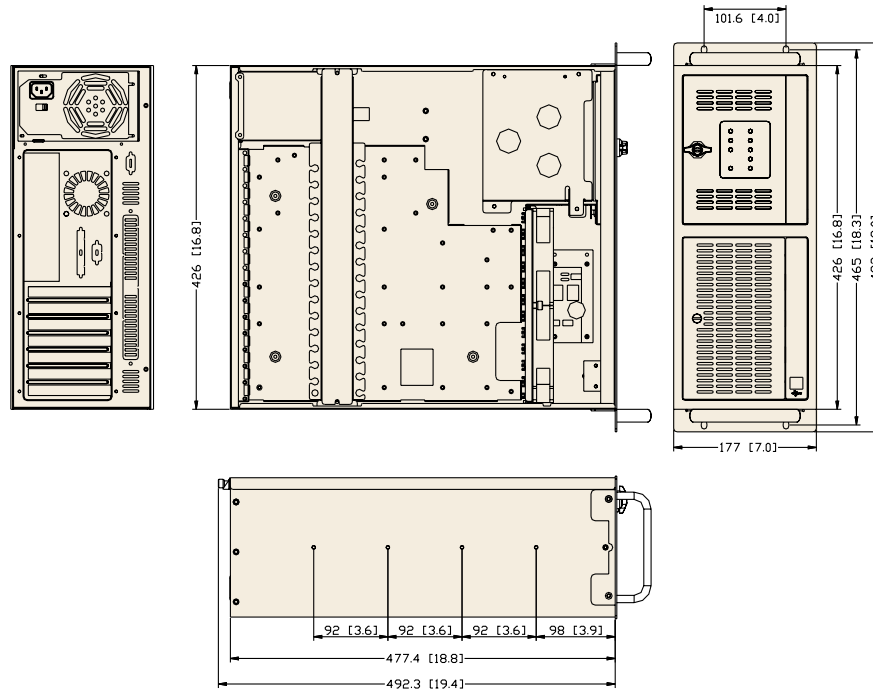

Unit: mm (inch)

Power Supply Options

Part Number	Specifications					
	Watt	Input	Output	Mini-load	Safety	MTBF
PS-300ATX-ZBE (ATX, PFC)	300 W	AC 100 ~ 240 V (full-range)	+5 V @ 30 A, +3.3 V @ 28 A +12 V @ 15 A, -12 V @ 0.8 A -5 V @ 0.3 A, +5 Vsb @ 2 A	+5 V @ 0.1 A +3.3 V @ 0.3 A	UL/TUV/CB/CCC	100,000 hours @ 25 °C
RRPS-300ATX-ZE (ATX, PFC)	300 W	AC 100 ~ 240 V (full-range)	+5 V @ 25 A, +3.3 V @ 18 A +12 V @ 16 A, -12 V @ 0.5 A -5 V @ 0.5 A, +5 Vsb @ 2 A	+5 V @ 3 A +3.3 V @ 1 A +12 V @ 2 A +5 Vsb @ 0.1 A	UL/TUV/CB/CCC	100,000 hours @ 25 °C
PS-400ATX-ZBE (ATX, PFC)	400W	AC 100 ~ 240 V (full range)	+5V @ 35A, +3.3V @ 25A +12V @ 30A, -12V @ 1.0A -5V @ 0.8A, +5Vsb @ 2A	+5V @ 3A, +3.3V @ 1A +12V @ 2A, +5Vsb @ 0.1A	UL/TUV/CB/CCC	91,000 hrs @ 25 °C

Ordering Information

Part Number	Power Supply	Motherboard	Regulation
ACP-4000MB-00XE	Without power supply, with ATX switch	Not included	-
ACP-4000MB-30ZE	PS-300ATX-ZBE	Not included	CE
ACP-4000MB-30RE	RPS-300ATX-ZE	Not included	CE
ACP-4000MB-40ZE	PS-400ATX-ZBE	Not included	CE

Accessories

Part Number	Description
19914K0010	Door filter 97.6 x 36.6 x 5 mm
1999615000	Fan filter 115 x 195 x 5 mm
96CD-52X-I-AS-B2	Black 5.25" CD-ROM
96DVR-40X-I-AS-B	Black 5.25" 16X/40X/24X DVDRW-ROM
96FDD-144-TE-B1	Black 3.5" FDD