

PLEASE CHECK WWW.MOLEX.COM FOR LATEST PART INFORMATION

Part Number: [0505359001](#)
Status: **Active**
Description: 2.50mm (.098") / 3.00mm (.118") Pitch Wire-to-Board Female Crimp Terminal, 16-18 AWG, Reel

Documents:

[Drawing \(PDF\)](#) [RoHS Certificate of Compliance \(PDF\)](#)
[Product Specification PS-51128-003 \(PDF\)](#)

General

Product Family	Crimp Terminals
Series	50535
Crimp Quality Equipment	Yes
Product Name	N/A

Physical

Gender	Female
Material - Metal	Brass
Material - Plating Mating	Tin
Material - Plating Termination	Tin
Packaging Type	Reel
Plating min: Mating (µin)	35
Plating min: Mating (µm)	0.88
Plating min: Termination (µin)	35
Plating min: Termination (µm)	0.88
Termination Interface: Style	Crimp or Compression
Wire Insulation Diameter	2.00-2.45mm (.079-.096")
Wire Size AWG	16, 18
Wire Size mm ²	N/A

Material Info

Reference - Drawing Numbers

Product Specification	PS-51128-003, RPS-51128-001, RPS-51128-002, RPS-51128-003
Sales Drawing	SD-50535-9*01

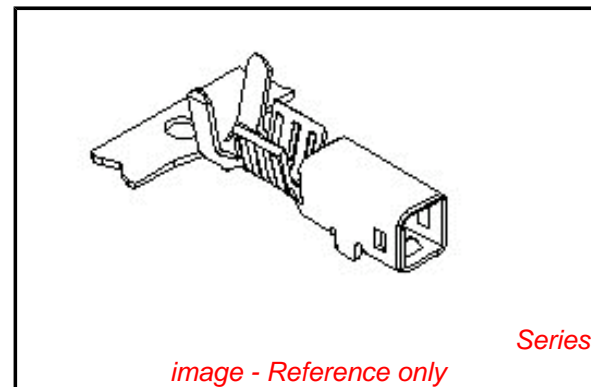

image - Reference only

EU RoHS

ELV and RoHS Compliant
REACH SVHC Contains SVHC: No
Halogen-Free Status

China RoHS



Need more information on product environmental compliance?

Email productcompliance@molex.com
 For a multiple part number RoHS Certificate of Compliance, [click here](#)

Please visit the [Contact Us](#) section for any non-product compliance questions.

Search Parts in this Series

[50535Series](#)

Use With

[51128-1601](#)

Application Tooling | FAQ

Tooling specifications and manuals are found by selecting the products below. Crimp Height Specifications are then contained in the Application Tooling Specification document.

Japan

Description	Product #
Applicator for M211A Bench Press, 16-18 AWG, for 50535 Crimp Terminal	0573193000

注記
NOTES

- 適合ハウジング : 51128-***01
APPLICABLE HOUSING : 51128-***01
- 材料 : 黄銅, 錫メッキ材 (t=0.32)
MATERIAL : PRE-TINNED BRASS (t=0.32)

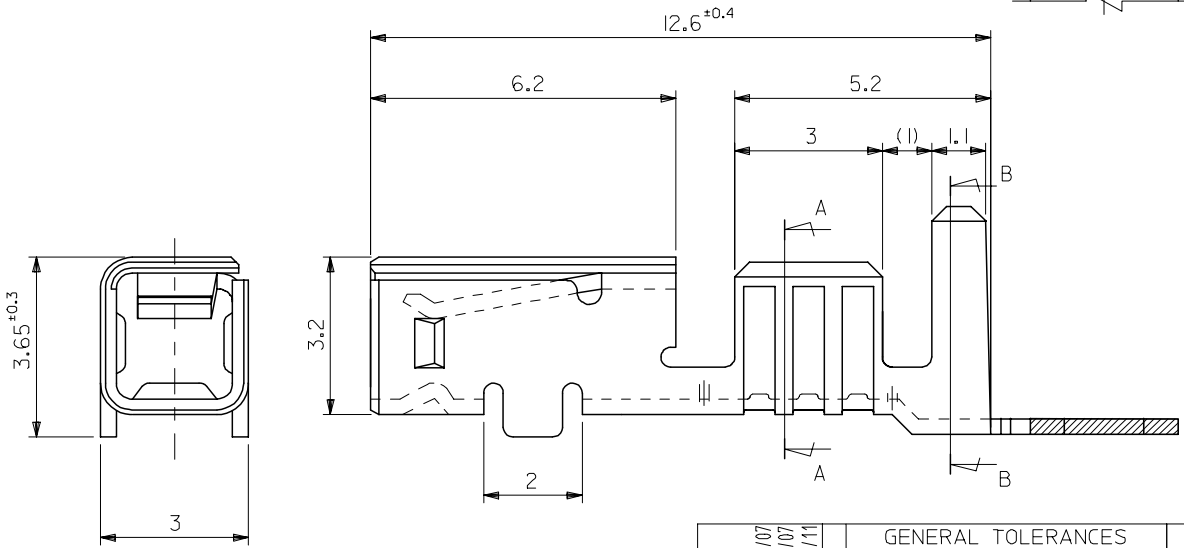
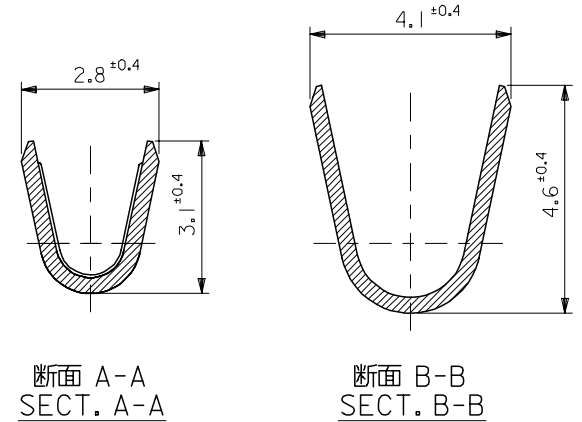

50535-9001	連鎖状 CHAIN
ENG. NO.	端子形状 FORM

REVISED EC NO: J2006-0426 DRW: HAYASHI CHK: DN, UKITA APPR: NUKITA	GENERAL TOLERANCES (UNLESS SPECIFIED)		DIMENSION STYLE MM ONLY		SCALE 10:1	DESIGN UNITS METRIC	THIRD ANGLE PROJECTION	
	10 UNDER	±0.2	DRAWN BY K. HAYASHI	DATE '94/07/01	TITLE 2.5/3.0 W/B CONN.(WITH FUSE)CRIMP RECEPTACLE			
	10 OVER 30 UNDER	±0.25	CHECKED BY M. OOYA M. SAK	DATE '95/06/08				
	30 OVER	±0.3	APPROVED BY M. ENOMOTO	DATE '95/06/08	MOLEX INCORPORATED			
ANGULAR	±3 °	MATERIAL NO. SEE CHART		DOCUMENT NO. SD-50535-9*01		SHEET NO. 1 OF 1		
DRAFT WHERE APPLICABLE MUST REMAIN WITHIN DIMENSIONS			SIZE A3		THIS DRAWING CONTAINS INFORMATION THAT IS PROPRIETARY TO MOLEX INCORPORATED AND SHOULD NOT BE USED WITHOUT WRITTEN PERMISSION			