

Screw Terminal Type

Discontinued



Series:GH

Japan

- Features Endurance : 85°C 2000 h
High-ripple-current product

U.S.A.

■ Specifications

Category temp. range	-25 to +85°C						
Rated W.V. Range	160 to 450 V .DC						
Nominal Cap. Range	220 to 18000 μ F						
Capacitance Tolerance	-10 to +30% (120Hz/+20°C)						
DC Leakage Current	$3\sqrt{CV}$ (μA) max. after 5 minutes application of rated working voltage at +20°C C:Capacitance(μF) V: W.V. (V.DC)						
Dissipation Factor	Please see the attached standard products list						
Endurance	After 2000 hours application of DC voltage with specified ripple current (\leq rated DC working voltage) at +85°C, the capacitor shall meet the following limits. <table border="1" style="width: 100%; margin-top: 5px;"> <tr> <td>Capacitance change</td> <td>$\pm 20\%$ of initial measured value</td> </tr> <tr> <td>D.F.</td> <td>$\leq 150\%$ of initial specified value</td> </tr> <tr> <td>DC leakage current</td> <td>\leq initial specified value</td> </tr> </table>	Capacitance change	$\pm 20\%$ of initial measured value	D.F.	$\leq 150\%$ of initial specified value	DC leakage current	\leq initial specified value
Capacitance change	$\pm 20\%$ of initial measured value						
D.F.	$\leq 150\%$ of initial specified value						
DC leakage current	\leq initial specified value						
Shelf Life	After storage for 1000hours at +85±2 °C with no voltage applied and then being stabilized at +20 °C, capacitors shall meet the limits specified in "Endurance".(With voltage treatment)						

■ Frequency Correction Factor for Ripple Current

W.V.(V)	φD(mm)	Freq.(Hz)	50	60	120	300	360	1k	10k to
160, 200	36		0.80	0.86	1.00	1.07	1.08	1.12	1.17
		51, 64	0.86	0.91	1.00	1.05	1.06	1.08	1.10
		77, 90	0.90	0.95	1.00	1.05	1.06	1.08	1.10
250, 350	36		0.71	0.79	1.00	1.09	1.10	1.15	1.21
		51, 64	0.83	0.88	1.00	1.07	1.08	1.13	1.20
		77, 90	0.85	0.90	1.00	1.05	1.06	1.11	1.20
400, 450	36		0.65	0.74	1.00	1.09	1.10	1.16	1.22
		54, 64	0.81	0.87	1.00	1.07	1.08	1.13	1.21
		77, 90	0.85	0.90	1.00	1.05	1.06	1.11	1.20

■ Dimensions in mm(not to scale)

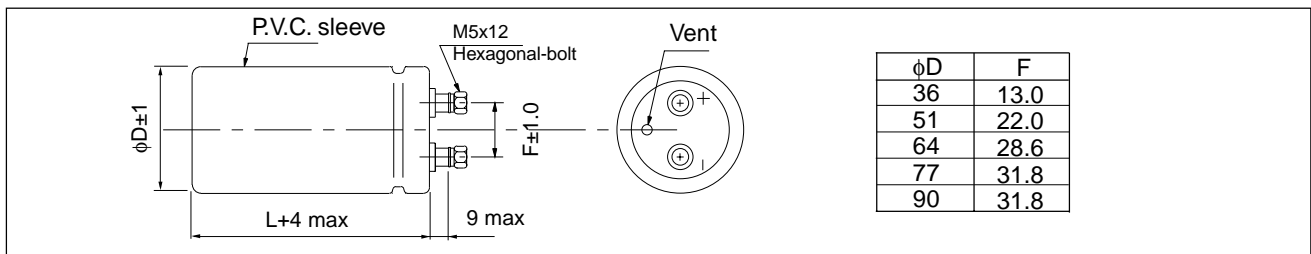

■ Mounting clamp

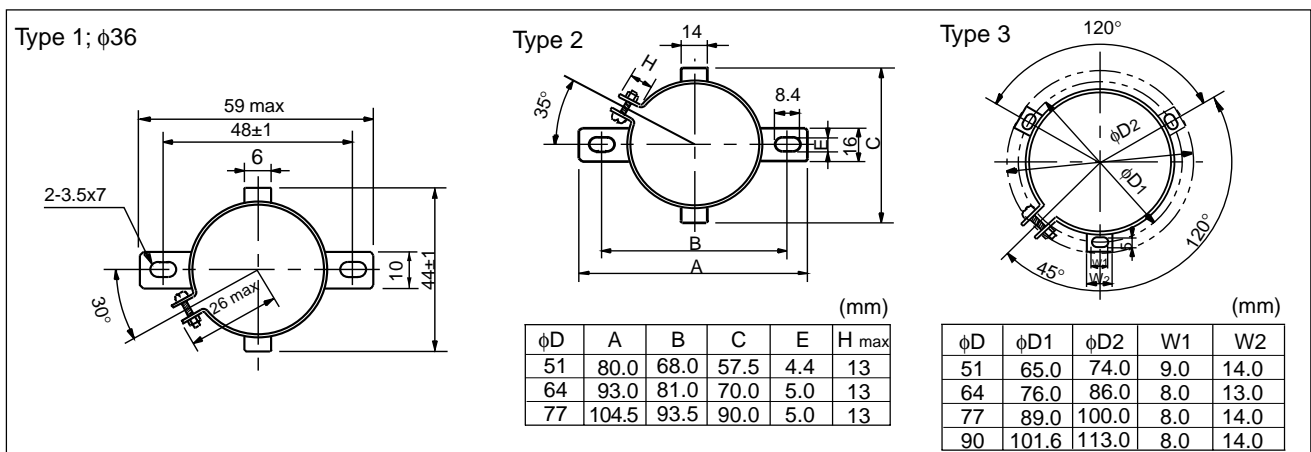

Design, Specifications are subject to change without notice. Ask factory for technical specifications before purchase and/or use. Whenever a doubt about safety arises from this product, please inform us immediately for technical consultation without fail.

■ Standard Products

Discontinued

W.V. (V)	Cap. (10 to+30%) (μF)	Case size		Specification		Terminal Pitch (mm)	Part No.	(:)Mounting Clamp		
		Dia. (mm)	Length (mm)	Ripple current (120Hz) (+85°C) (A)	D.F. (120Hz) (+20°C)			No	2point clamp	3point clamp
160	1500	36	83	4.13	0.1	13.0	ECEG2CH152P()	N	F	
	1800	36	103	5.00	0.1	13.0	ECEG2CH182N()	N	F	
	2200	36	125	5.88	0.1	13.0	ECEG2CH222M()	N	F	
	2700	51	83	6.88	0.1	22.0	ECEG2CH272L()	N	C	F
	3900	51	103	8.75	0.1	22.0	ECEG2CH392K()	N	C	F
	4700	51	125	10.6	0.1	22.0	ECEG2CH472J()	N	C	F
	5600	51	145	12.2	0.1	22.0	ECEG2CH562H()	N	C	F
			64	103	12.2	0.1	28.6	ECEG2CH562G()	N	C
	6800	64	125	14.4	0.1	28.6	ECEG2CH682F()	N	C	F
	8200	64	145	16.9	0.1	28.6	ECEG2CH822E()	N	C	F
	10000	77	125	19.4	0.1	31.8	ECEG2CH103D()	N	C	F
	12000	77	145	22.5	0.1	31.8	ECEG2CH123C()	N	C	F
	18000	90	150	31.2	0.1	31.8	ECEG2CH183A()	N		F
200	1200	36	83	3.63	0.1	13.0	ECEG2DH122P()	N	F	
	1500	36	103	4.50	0.1	13.0	ECEG2DH152N()	N	F	
	1800	36	125	5.38	0.1	13.0	ECEG2DH182M()	N	F	
	2200	51	83	6.25	0.1	22.0	ECEG2DH222L()	N	C	F
	2700	51	103	7.38	0.1	22.0	ECEG2DH272K()	N	C	F
	3900	51	125	9.50	0.1	22.0	ECEG2DH392J()	N	C	F
	4700	51	145	11.2	0.1	22.0	ECEG2DH472H()	N	C	F
			64	103	11.2	0.1	28.6	ECEG2DH472G()	N	C
	5600	64	125	13.1	0.1	28.6	ECEG2DH562F()	N	C	F
	6800	64	145	15.6	0.1	28.6	ECEG2DH682E()	N	C	F
	10000	77	125	19.4	0.1	31.8	ECEG2DH103D()	N	C	F
	12000	77	145	22.5	0.1	31.8	ECEG2DH123C()	N	C	F
15000	90	150	28.1	0.1	31.8	ECEG2DH153A()	N		F	
250	820	36	83	3.06	0.1	13.0	ECEG2EH821P()	N	F	
	1000	36	103	3.75	0.1	13.0	ECEG2EH102N()	N	F	
	1200	36	125	4.38	0.1	13.0	ECEG2EH122M()	N	F	
	1500	51	83	5.13	0.1	22.0	ECEG2EH152L()	N	C	F
	2200	51	103	6.75	0.1	22.0	ECEG2EH222K()	N	C	F
	2700	51	125	8.13	0.1	22.0	ECEG2EH272J()	N	C	F
	3300	51	145	9.25	0.1	22.0	ECEG2EH332H()	N	C	F
			64	103	9.25	0.1	28.6	ECEG2EH332G()	N	C
	3900	64	125	11.0	0.1	28.6	ECEG2EH392F()	N	C	F
	4700	64	145	12.5	0.1	28.6	ECEG2EH472E()	N	C	F
	6800	77	125	16.2	0.1	31.8	ECEG2EH682D()	N	C	F
	8200	77	145	18.7	0.1	31.8	ECEG2EH822C()	N	C	F
10000	90	150	23.1	0.1	31.8	ECEG2EH103A()	N		F	
350	390	36	83	2.13	0.1	13.0	ECEG2VH391P()	N	F	
	470	36	103	2.56	0.1	13.0	ECEG2VH471N()	N	F	
	560	36	125	3.00	0.1	13.0	ECEG2VH561M()	N	F	

Endurance : 85°C 2000h

Design, Specifications are subject to change without notice. Ask factory for technical specifications before purchase and/or use. Whenever a doubt about safety arises from this product, please inform us immediately for technical consultation without fail.

Discontinued

■ Standard Products

W.V. (V)	Cap. (10 to +30%) (μ F)	Case size		Specification		Terminal Pitch (mm)	Part No.	(:) Mounting Clamp		
		Dia. (mm)	Length (mm)	Ripple current (120Hz) (+85°C) (A)	D.F. (120Hz) (+20°C)			No	2point clamp	3point clamp
350	820	51	83	3.75	0.1	22.0	ECEG2VH821L()	N	C	F
	1000	51	103	4.50	0.1	22.0	ECEG2VH102K()	N	C	F
	1200	51	125	5.38	0.1	22.0	ECEG2VH122J()	N	C	F
		51	145	5.75	0.1	22.0	ECEG2VH122H()	N	C	F
	1500	64	103	6.50	0.1	28.6	ECEG2VH152G()	N	C	F
	1800	64	125	7.63	0.1	28.6	ECEG2VH182F()	N	C	F
	2200	64	145	8.75	0.1	28.6	ECEG2VH222E()	N	C	F
	3300	77	125	11.2	0.1	31.8	ECEG2VH332D()	N	C	F
	3900	77	145	13.1	0.1	31.8	ECEG2VH392C()	N	C	F
5600	90	150	17.5	0.1	31.8	ECEG2VH562A()	N		F	
400	270	36	83	1.75	0.1	13.0	ECEG2GH271P()	N	F	
	390	36	103	2.31	0.1	13.0	ECEG2GH391N()	N	F	
	470	36	125	2.75	0.1	13.0	ECEG2GH471M()	N	F	
	560	51	83	3.13	0.1	22.0	ECEG2GH561L()	N	C	F
	820	51	103	4.13	0.1	22.0	ECEG2GH821K()	N	C	F
	1000	51	125	4.88	0.1	22.0	ECEG2GH102J()	N	C	F
	1200	51	145	5.75	0.1	22.0	ECEG2GH122H()	N	C	F
		64	103	5.75	0.1	28.6	ECEG2GH122G()	N	C	F
	1500	64	125	6.88	0.1	28.6	ECEG2GH152F()	N	C	F
	1800	64	145	8.00	0.1	28.6	ECEG2GH182E()	N	C	F
	2700	77	125	10.2	0.1	31.8	ECEG2GH272D()	N	C	F
	3300	77	145	12.0	0.1	31.8	ECEG2GH332C()	N	C	F
3900	90	150	14.4	0.1	31.8	ECEG2GH392A()	N		F	
450	220	36	83	1.63	0.1	13.0	ECEG2WH221P()	N	F	
	330	36	103	2.13	0.1	13.0	ECEG2WH331N()	N	F	
	390	36	125	2.50	0.1	13.0	ECEG2WH391M()	N	F	
	560	51	83	3.13	0.1	22.0	ECEG2WH561L()	N	C	F
	680	51	103	3.75	0.1	22.0	ECEG2WH681K()	N	C	F
	820	51	125	4.50	0.1	22.0	ECEG2WH821J()	N	C	F
	1000	51	145	5.25	0.1	22.0	ECEG2WH102H()	N	C	F
	1200	64	103	5.75	0.1	28.6	ECEG2WH122G()	N	C	F
		64	125	6.25	0.1	28.6	ECEG2WH122F()	N	C	F
	1500	64	145	7.25	0.1	28.6	ECEG2WH152E()	N	C	F
	2200	77	125	9.25	0.1	31.8	ECEG2WH222D()	N	C	F
	2700	77	145	10.9	0.1	31.8	ECEG2WH272C()	N	C	F
3900	90	150	14.4	0.1	31.8	ECEG2WH392A()	N		F	

Endurance : 85°C 2000 h