

PLEASE CHECK WWW.MOLEX.COM FOR LATEST PART INFORMATION

Part Number: [0345111001](#)
Status: **Active**
Description: 1.2mm (.047") 4 Circuit Sealed Housing

Documents:

[Drawing \(PDF\)](#) [RoHS Certificate of Compliance \(PDF\)](#)
[Product Specification PS-34511-555 \(PDF\)](#)

General

Product Family Crimp Housings
 Series [34511](#)
 Product Name N/A

Physical

Circuits (maximum) 4
 Color - Resin Black
 Gender Female
 Glow-Wire Compliant No
 Keying to Mating Part Yes
 Lock to Mating Part Yes
 Material - Resin Modified Polystyrene Alloy, Silicone
 Number of Rows 1
 Packaging Type Bag
 Panel Mount No
 Pitch - Mating Interface (in) 0.160 In
 Pitch - Mating Interface (mm) 4.00 mm
 Pitch - Term. Interface (in) 0.160 In
 Pitch - Term. Interface (mm) 4.00 mm
 Polarized to Mating Part Yes
 Ports 4
 Stackable No
 Temperature Range - Operating -40°C to +125°C

Material Info

Reference - Drawing Numbers

Product Specification PS-34511-555
 Sales Drawing SD-34511-001

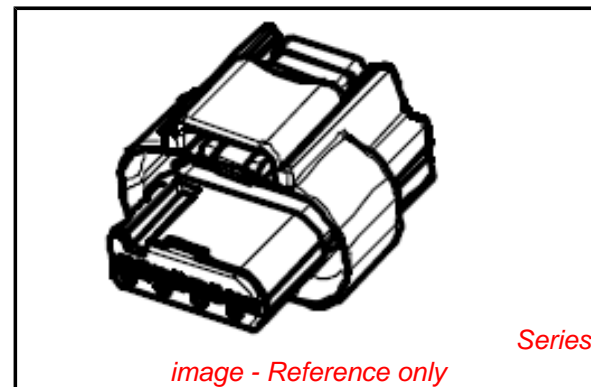

EU RoHS

**ELV and RoHS
 Compliant**
REACH SVHC
 Not Reviewed
**Halogen-Free
 Status**
Not Reviewed

China RoHS



**Need more information on product
 environmental compliance?**

Email productcompliance@molex.com
 For a multiple part number RoHS Certificate of
 Compliance, [click here](#)

Please visit the [Contact Us](#) section for any
 non-product compliance questions.

Search Parts in this Series
[34511Series](#)

ASSEMBLY PART NO.	TPA PART NO.	CONNECTOR HOUSING NO.	TERMINAL HOUSING		KEYING OPTION	NUMBER OF PLUGGED POSITIONS	CAVITY STATUS (X = PLUGGED)				TOOLED
			PART NUMBER	COLOR			1	2	3	4	
34511-1001	34514-0001	34512-0001	34513-0001	BLACK	A	0					X
34511-1002	34514-0002	34512-0001	34513-0002	LIGHT GRAY	B	0					
34511-1003	34514-0003	34512-0001	34513-0003	BROWN	C	0					
34511-1004	34514-0004	34512-0001	34513-0004	DARK GRAY	D	0					
34511-1011	34514-0001	34512-0002	34513-0001	BLACK	A	2	X	X			X

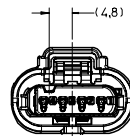

KEYING OPTION A

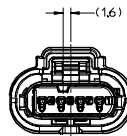

KEYING OPTION B

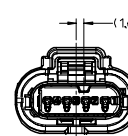

KEYING OPTION C

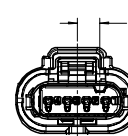

KEYING OPTION D

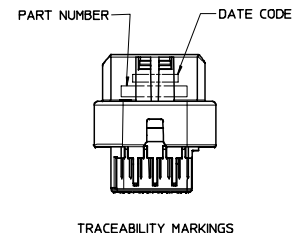
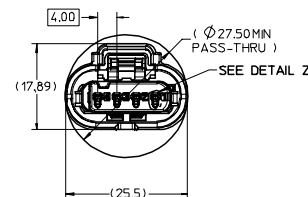
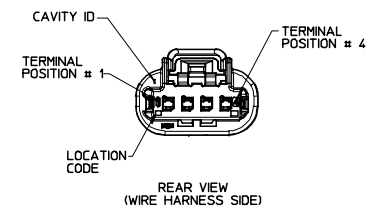
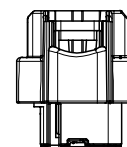
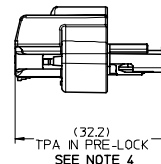
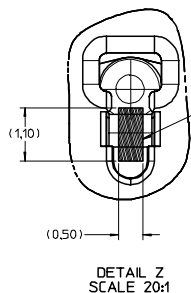
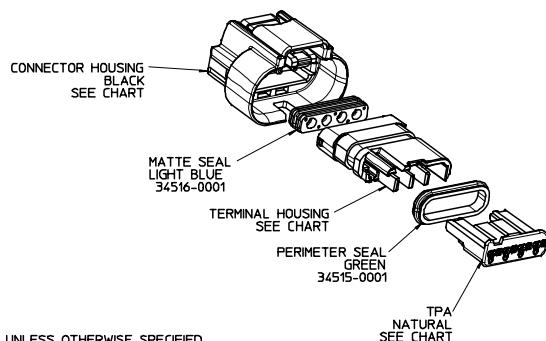

NOTES: UNLESS OTHERWISE SPECIFIED.

- MATERIAL
PLASTIC: GLASS FILLED SPS RESIN
SEALS: SILICONE
- FOR RECEPTACLE TERMINAL TO BE USED WITH THIS ASSEMBLY SEE MOLEX DRAWING SD-33468-001. TERMINAL BOX AND CRIMP SHOULD BE PARALLEL TO EACH OTHER WITHIN ONE DEGREE (1°) TO PREVENT TERMINAL STUBBING.
- DESIGNED TO MATE WITH HIRSCHMANN DRAWING 872-975-XXX VARIANTE 1 WITH FORM 1 BLADES ON DRAWING 1 99 51 50733 1.
- ASSEMBLY SHIPPED WITH TPA IN PRE-LOCK POSITION. EACH TPA MUST BE SNAPPED INTO FINAL LOCK POSITION UPON FULL TERMINAL ASSEMBLY.
- SYSTEM TO BE USED WITH SAE 18 AWG, 20 AWG AND 22 AWG WIRES WITH DIAMETERS IN THE RANGE OF 1.5 MM TO 2.13 MM.
- TO PREVENT TERMINAL BEAM DAMAGE, USE RECTANGULAR FLAT TIPPED PROBES FOR TERMINAL PROBING.
- TPA FORCES
A. ENGAGEMENT FORCE - WITH TERMINALS (PRE-LOCK TO FINAL-LOCK): 70 N MAX
B. DISENGAGEMENT FORCE - WITH TERMINALS (FINAL-LOCK TO PRE-LOCK): 15N MIN
- FOR RECYCLING INFORMATION CONTACT MOLEX.
- SHALL CONFORM TO THE FOLLOWING PACKAGING SPECIFICATION NUMBER: PK-31300-163
- FINISHED ASSEMBLIES TO BE MARKED WITH DATE CODE AND PART NUMBER.
- TPA'S MAY BECOME SEATED DURING TRANSIT. IF THIS OCCURS, TPA'S SHOULD BE MOVED TO THE PRE-LOCKED POSITION PRIOR TO FEMALE TERMINAL INSTALLATION.
- FORCE TO BE APPLIED TO SECONDARY LOCK FOR CAVITY DAMAGE SUSCEPTIBILITY TESTING (USCAR 5.4.9) TO BE 60 N.



EC NO: UAU2006-0517 DRWNSVZYL 2006/04/07 CHKDSVZYL 2006/04/10 APPR:SMARCEAU2006/04/10	QUALITY SYMBOLS	GENERAL TOLERANCES (UNLESS SPECIFIED)	SCALE 2:1	DESIGN UNITS METRIC	THIRD ANGLE PROJECTION	REVISE ON CAD ONLY
	0.1 0.2	mm INCH 4 PLACES ±--- ±--- 3 PLACES ±--- ±--- 2 PLACES ±--- ±--- 1 PLACE ±--- ±--- ANGULAR ±---°	DIMENSION STYLE MM ONLY DRAWN BY P.JOSHI DATE 022004 CHECKED BY B.FLOWER DATE 022004 APPROVED BY S.MARCEAU DATE 022004	TITLE	CONNECTOR ASSEMBLY 4 CKT 1.2 MM SEALED	
DRAFT WHERE APPLICABLE MUST REMAIN WITHIN DIMENSIONS	MOLEX INCORPORATED MATERIAL NO. SEE CHART DOCUMENT NO. SD-34511-001 SHEET NO. 1 OF 1		THIS DRAWING CONTAINS INFORMATION THAT IS PROPRIETARY TO MOLEX INCORPORATED AND SHOULD NOT BE USED WITHOUT WRITTEN PERMISSION			