

UbiQ-230T

One-Touch Scenario Control Panel with 3.5" Color LCD

NEW



Features

- Seven programmable scenario keys
- 3.5" color Touch TFT LCD
- Built-in IR receiver
- Remote Manager tool for SI development
- Replaceable faceplate
- Dimmer package supported
- Ethernet & RS-485 interface
- Modbus & UPNP supported

Introduction

The UbiQ-230T, a 3.5" scenario control panel with seven programmable hot keys for one-touch operation, is a new member of the Advantech control panel family that targets the Home/Building-Residential/Commercial Automation fields. It seamlessly integrates seven front-bezel keys for intuitive selection of home scenarios and four D I/O, an RS-232, RS-422 & RS-485 ports for versatile protocol connections. Also, UbiQ-230T operates like a traditional control panel offering a simple interface with flexible and expandable control protocols such as RS-485, LonWorks®, DALI, and Modbus to provide versatile control capacities. The UbiQ-230T offers scheduled energy management of home lighting, HVAC, blind, dimmer and power devices to deliver the perfect way of creating a home comfort zone. In addition, the UbiQ-230T dimmers and relays are included in the Scenario control package, so system integrators can easily build Smart Home applications.

Product Highlights

The UbiQ-230T's smart and friendly scenario keys and vivid color touch panel puts personal comfort zones within easy reach:

- 1. Seven programmable scenario keys and touchscreen for unlimited scenario setting
- 2. Home scenario modes make customized lighting, HVAC, blind, audio and video device preferences available with one touch.
- 3. Scenario manager tool for system integrators to further customize home scenario configuration through a PC.

Specifications

Motherboard	Kernel	32-bit ARM 9 Low Voltage 200 MHz SDRAM: 64 MB Flash: 128 MB
Audio	1 W speaker Line-out	
Control Protocol Options	Default	RS-485 SSP is reserved for other protocols
Display	DataImage 3.5" Touch TFT LCD with 240 x 320 resolution LCD Power Control	3.3 V VDD, 5 V VBK Control & Bus
I/O Ports	Ethernet Serial ports Consumer IR receiver for remote control, up to 10 meters Fully compatible with UbiQ-310	10/100Base-Tx 1 x RS-485, 1 x SSP
Power Supply	DC-in	12 V _{DC}
Software	OS Utilities	Windows CE 5.0 (Core Version) Advantech Scenario manager for configuration by SIs
Mechanical Specifications	Wall box for Installer Plastic Enclosure Dimensions (W x H x D) Weight Reserved	9.1 x 12.1 x 1.0 cm (3.58" x 4.76" x 0.39") 260 g (0.57 lb) 1 x RS-485 Phoenix type connector
Environment Specifications	Operating Temperature Relative humidity Safety EMS EMI	32 ~ 104° F (0° C ~ 40° C) 10 ~ 95% @ 40° C (non-condensing) UL, CUL, CE CE Class B FCC, CE Class B

System Dimensions

Unit: mm

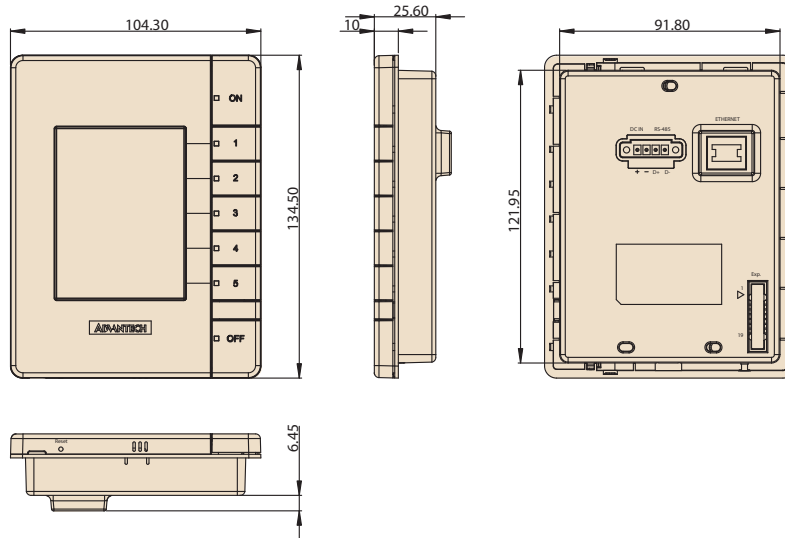

Wallbox Dimensions

Unit: mm

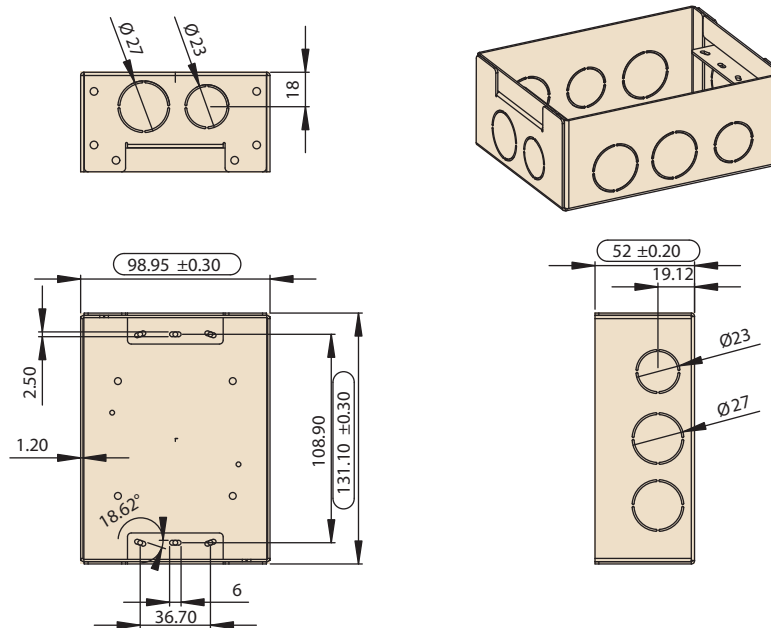

Ordering Information

Part Number	Description
UbiQ-230T-CE0E	3.5" Scenario Controller with touch panel
UbiQ-Dimmer-04	Liteputer EDX-F04 4Ch Dimmer w/UbiQ protocol
UbiQ-230-Wallbox	In-wall box for UbiQ-230

Packing List

Description	Quantity
CD Utility	1
Cable	1
Mounting frame	1
Screws	1
Deco plate	1