

Silicon PNP Power Transistors

2SA1635

DESCRIPTION

- With TO-220Fa package
- Low collector saturation voltage
- Complement to type 2SC4008

APPLICATIONS

- For medium speed, electrical supply and DC-DC converter applications

PINNING

PIN	DESCRIPTION
1	Emitter
2	Collector
3	Base

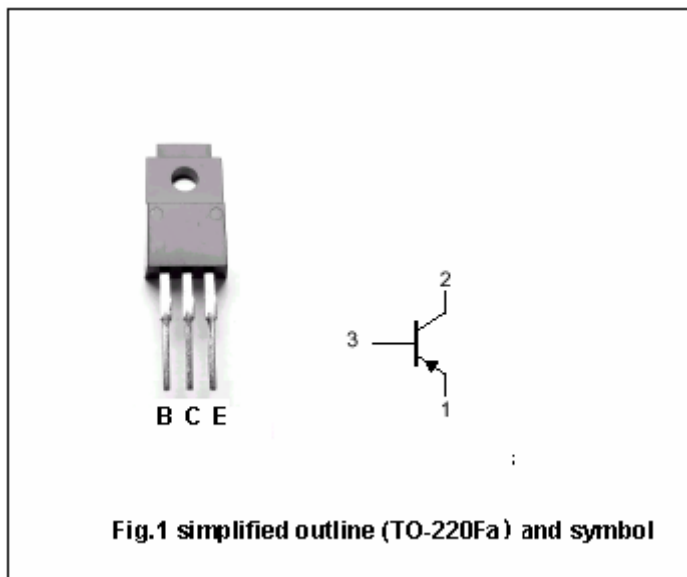

Absolute maximum ratings(Ta=25°C)

SYMBOL	PARAMETER	CONDITIONS	VALUE	UNIT
V_{CBO}	Collector-base voltage	Open emitter	-80	V
V_{CEO}	Collector-emitter voltage	Open base	-80	V
V_{EBO}	Emitter-base voltage	Open collector	-5	V
I_C	Collector current		-4	A
P_C	Collector power dissipation	$T_C=25^\circ\text{C}$	30	W
T_j	Junction temperature		150	$^\circ\text{C}$
T_{stg}	Storage temperature		-55~150	$^\circ\text{C}$

Silicon PNP Power Transistors

2SA1635

CHARACTERISTICS

T_j=25°C unless otherwise specified

SYMBOL	PARAMETER	CONDITIONS	MIN	TYP.	MAX	UNIT
V _{(BR)CEO}	Collector-emitter breakdown voltage	I _C =-1mA, I _B =0	-80			V
V _{(BR)EBO}	Emitter-base breakdown voltage	I _E =-0.1mA, I _C =0	-5			V
V _{CEsat}	Collector-emitter saturation voltage	I _C =-2A; I _B =-0.2A			-1.5	V
V _{BE sat}	Base-emitter saturation voltage	I _C =-2A; I _B =-0.2A			-1.5	V
I _{CBO}	Collector cut-off current	V _{CB} =-80V; I _E =0			-10	μ A
I _{EBO}	Emitter cut-off current	V _{EB} =-5V; I _C =0			-10	μ A
h _{FE}	DC current gain	I _C =-1A; V _{CE} =-4V	60		320	
C _{OB}	Output capacitance	I _E =0; V _{CB} =-10V; f=1MHz		80		pF
f _T	Transition frequency	I _C =-0.5A; V _{CE} =-12V		12		MHz

◆ h_{FE} Classifications

D	E	F
60-120	100-200	160-320

Silicon PNP Power Transistors

2SA1635

PACKAGE OUTLINE

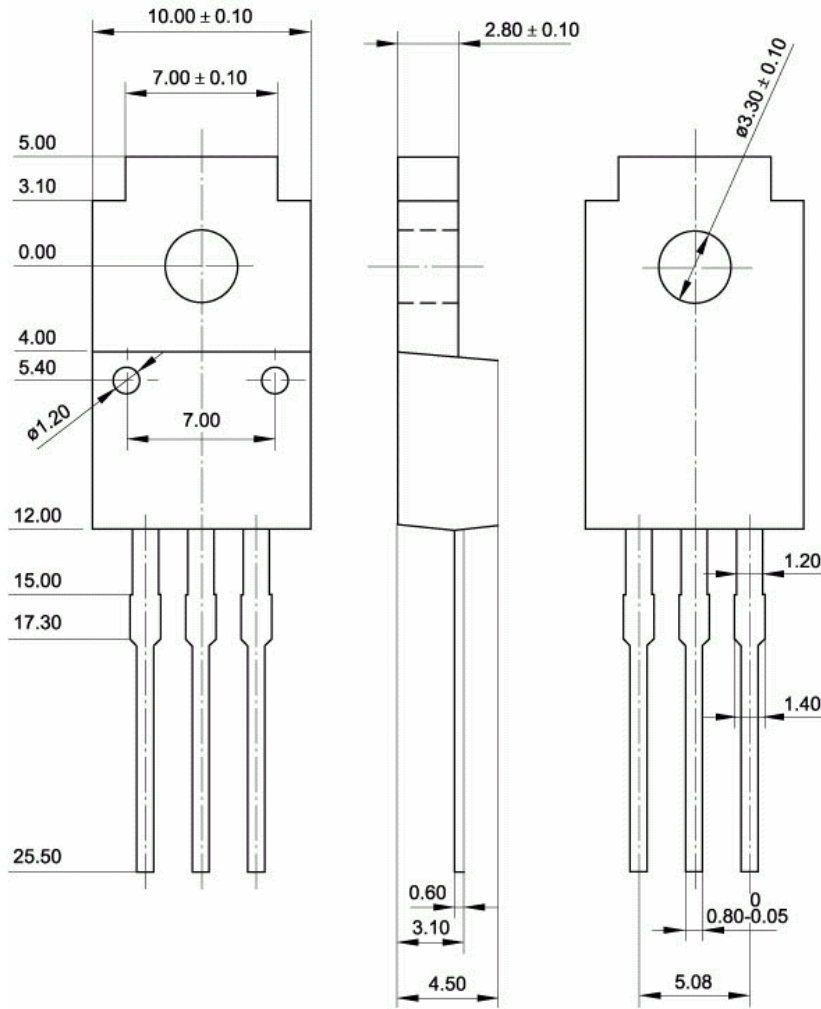

Fig.2 Outline dimensions (unindicated tolerance: ± 0.15 mm)