

FEATURES

- 20,000 Hour Life 85°C
- RoHS Compliant

SPECIFICATIONS

Items	Performance					
Operating Temperature Range	-40°C ~ +85°C					
Capacitance Tolerance	±20% (at 120Hz, 20°C)					
Leakage Current (at 20°C)	I = 0.01CV or 5 mA whichever is smaller (after 5 minutes) Where, C= rated capacitance in F. V= rated DC working voltage in V.					
Dissipation Factor (Tan at 120Hz, 20°C)	Rated Voltage	350 ~ 450				
	Tan (max)	0.15				
Low Temperature Characteristics (at 120Hz)	Capacitance change: C(-25 °C) / C(+20 °C) ≥ 0.7					
Load Life Test	Test Time	20,000 Hrs				
	Capacitance Change	Within ±20% of initial value				
	Dissipation Factor	Less than 200% of specified value				
	Leakage Current	Within specified value				
	* The above specifications shall be satisfied when the capacitors are restored to 20°C after subjected to DC voltage with rated ripple current applied for 20,000 hrs at 85 °C.					
Shelf Life Test	Test Time	1,000 Hrs				
	Capacitance Change	Within ±20% of initial value				
	Dissipation Factor	Less than 200% of specified value				
	Leakage Current	Within specified value				
	* The above specifications shall be satisfied when the capacitors are restored to 20°C after exposing them for 1,000 hrs at 85°C without voltage applied. The rated voltage shall be applied to the capacitors before the measurements (Refer to JIS C 5102-4.4).					
Ripple Current & Frequency Multipliers	Frequency (Hz)	50/60	120	300	1K	10K up
	Multiplier	0.7	1.0	1.1	1.3	1.4
Ripple Current & Temperature Multipliers	Temperature (°C)	40	60	85		
	Multiplier	2.44	2.2	1.0		
Standards	JIS C 5101-4					

PART NUMBER EXAMPLE

MEQ 102 M 2V B075

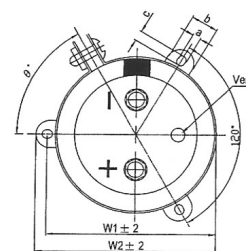
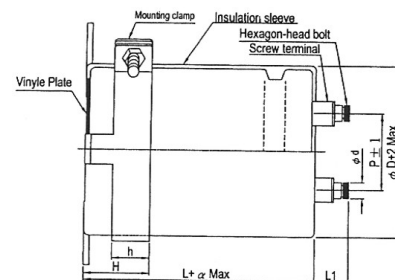
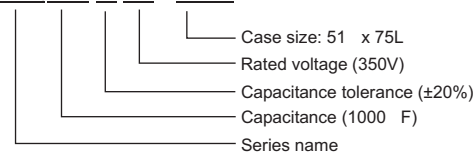

DIMENSIONS

unit: mm

D	P	L1	W1	W2	H	h	a	b	c		
51	22.0	2	10	61.0	65.5	21.0	15.0	7.0	12.0	4.5	60.0
64	28.6	2	10	72.5	78.0	25.0	20.0	7.0	14.0	4.5	60.0
77	32.0	2	10	85.5	91.0	35.0	20.0	8.0	16.0	4.5	60.0
90	32.0	2	10	101	106.0	34.5	20.0	8.0	16.0	4.5	60.0

Screw Specifications:
Plus hexagon-headed screw: M5 x 0.8 x 10
Max. screw tightening torque: 3.23Nm

DIMENSIONS & PERMISSIBLE RIPPLE CURRENT

V.DC Item F	350V (2V)				400V (2G)				450V (2W)			
	Size Code	D x L	Tan	Ripple Current	Size Code	D x L	Tan	Ripple Current	Size Code	D x L	Tan	Ripple Current
1,000	B075	51 x 75	0.15	3.8	B075	51 x 75	0.15	3.8	B096	51 x 96	0.15	4.2
1,200	B075	51 x 75	0.15	4.2	B096	51 x 96	0.15	4.6	B115	51 x 115	0.15	5.0
1,500	B096	51 x 96	0.15	5.2	B115	51 x 115	0.15	5.5	B130	51 x 130	0.15	5.8
1,800	B096	51 x 96	0.15	5.6	B130	51 x 130	0.15	6.4	C096	64 x 96	0.15	6.2
2,200	B130	51 x 130	0.15	7.10	C096	64 x 96	0.15	6.9	C115	64 x 115	0.15	7.4
2,700	C096	64 x 96	0.15	7.60	C115	64 x 115	0.15	8.2	C130	64 x 130	0.15	8.6
									D115	77 x 115	0.15	8.7
3,300	C115	64 x 115	0.15	9.00	C130	64 x 130	0.15	9.5	C155	64 x 155	0.15	10.2
									D130	77 x 130	0.15	10.0
3,900	C130	64 x 130	0.15	10.3	C155	64 x 155	0.15	11.1	D155	77 x 155	0.15	11.7
					D15	77 x 115	0.15	10.4				
4,700	C155	64 x 155	0.15	12.2	D130	77 x 130	0.15	12.0	D155	77 x 155	0.15	12.9
	D115	77 x 115	0.15	11.5					x			
5,600	D130	77 x 130	0.15	13.1	D155	77 x 155	0.15	14.4	E157	90 x 157	0.15	14.9
6,800	D155	77 x 155	0.15	15.5	E157	90 x 157	0.15	16.5				
8,200	E157	90 x 157	0.15	18.1	E157	90 x 157	0.15	18.1				
10,000	E157	90 x 157	0.15	19.9								