

SPECIFICATION FOR APPROVAL

REF : 20081111-B

PAGE: 1

PROD. NAME	SHIELDED SMD POWER INDUCTOR	ABC'S DWG NO.	SS6028□□□□L□-□□□
		ABC'S ITEM NO.	

I . MECHANICAL DIMENSIONS :

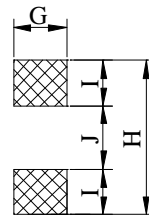
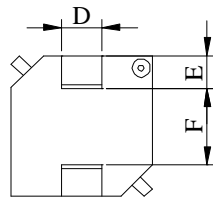
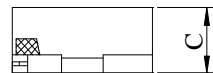
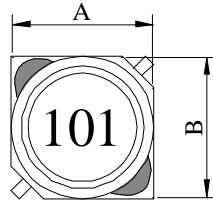

A :	6.00±0.3	m/m
B :	6.00±0.3	m/m
C :	2.8 ±0.3	m/m
D :	2.0 ±0.3	m/m
E :	1.9 typ.	m/m
F :	2.2 ref.	m/m
G :	2.4 ref.	m/m
H :	6.7 ref.	m/m
I :	2.3 ref.	m/m
J :	2.1 ref.	m/m

(PCB Pattern Suggestion)

II . SCHEMATIC DIAGRAM :

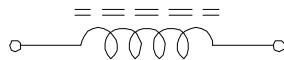

III . MATERIALS LIST :

- a . Core : Ferrite DR core
- b . Core : Ferrite RI core
- c . Wire : Enamelled copper wire (class F)
- d . Base : LCP Base
- e . Terminal : Cu/Ni/Sn
- f . Adhesive : Epoxy resin
- g . Remark : Products comply with RoHS' requirements

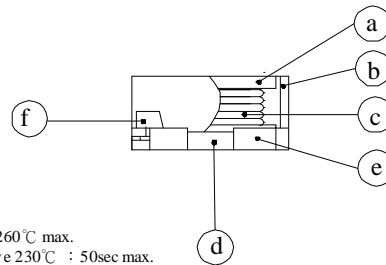

Peak Temp : 260°C max.
 Max time above 230°C : 50sec max.
 Max time above 200°C : 70sec max.

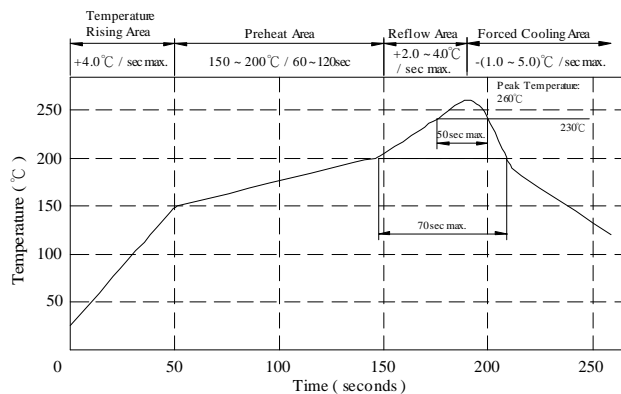

IV . GENERAL SPECIFICATION :

- a . Storage Temp. : -40°C ---+125°C
- b . Operating Temp. : -40°C ---+125°C
(Temp. rise Included)
- c . Resistance to solder heat : 260°C .10 secs.

AR-001A

SPECIFICATION FOR APPROVAL

PROD. NAME	SHIELDED SMD POWER INDUCTOR	ABC'S DWG NO.	SS6028□□□□L□-□□□
		ABC'S ITEM NO.	

V . ELECTRICAL CHARACTERISTICS :

DWG No.	Inductance (uH)	Test Freq. (Hz)	RDC (Ω) max.	Irms (A)	Isat (A)
SS60281R0ML□-□□□	1.0±20%	1K	0.022	3.80	3.00
SS60281R5ML□-□□□	1.5±20%	1K	0.025	3.20	2.50
SS60282R2ML□-□□□	2.2±20%	1K	0.032	3.00	2.20
SS60283R3ML□-□□□	3.3±20%	1K	0.044	1.92	1.55
SS60284R7ML□-□□□	4.7±20%	1K	0.050	1.80	1.35
SS60286R8ML□-□□□	6.8±20%	1K	0.070	1.45	1.20
SS6028100ML□-□□□	10.0±20%	1K	0.105	1.20	1.00
SS6028150ML□-□□□	15.0±20%	1K	0.140	1.00	0.80
SS6028220ML□-□□□	22.0±20%	1K	0.220	0.80	0.65
SS6028330ML□-□□□	33.0±20%	1K	0.280	0.65	0.55
SS6028470ML□-□□□	47.0±20%	1K	0.380	0.55	0.48
SS6028680ML□-□□□	68.0±20%	1K	0.600	0.45	0.38
SS6028101ML□-□□□	100.0±20%	1K	0.840	0.38	0.31
SS6028151ML□-□□□	150.0±20%	1K	1.200	0.30	0.26
SS6028221ML□-□□□	220.0±20%	1K	1.700	0.25	0.22
SS6028331ML□-□□□	330.0±20%	1K	2.450	0.20	0.17
SS6028471ML□-□□□	470.0±20%	1K	3.600	0.17	0.14
SS6028681ML□-□□□	680.0±20%	1K	5.400	0.13	0.11
SS6028102ML□-□□□	1000.0±20%	1K	8.200	0.11	0.09

1). □ : Packaging Information... **A** : Bulk **B** : Taping Reel

2). "- □□□": Reference code

3). L Test Freq. : 1KHz / 0.5V

4). Irms base on Temp. rise 40°C Max.

5). Isat base on ΔL/L0A=25% Max.

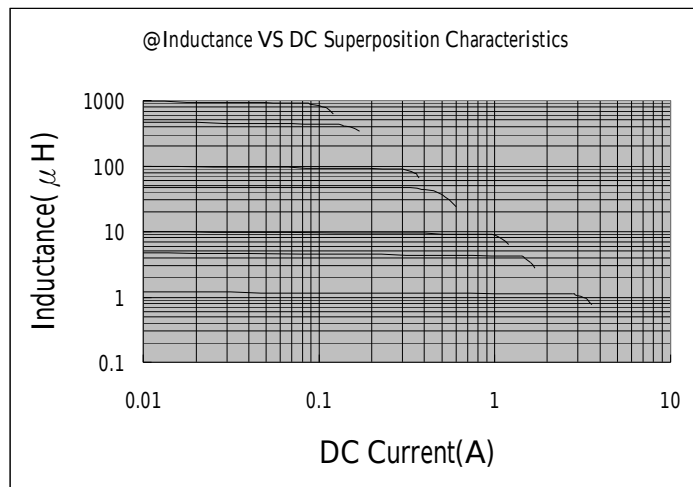

SPECIFICATION FOR APPROVAL

REF : 20081111-B

PAGE: 3

PROD. NAME	SHIELDED SMD POWER INDUCTOR	ABC'S DWG NO.	SS6028□□□□L□-□□□
		ABC'S ITEM NO.	

VI . PACKAGING INFORMATION :

(1) Configuration

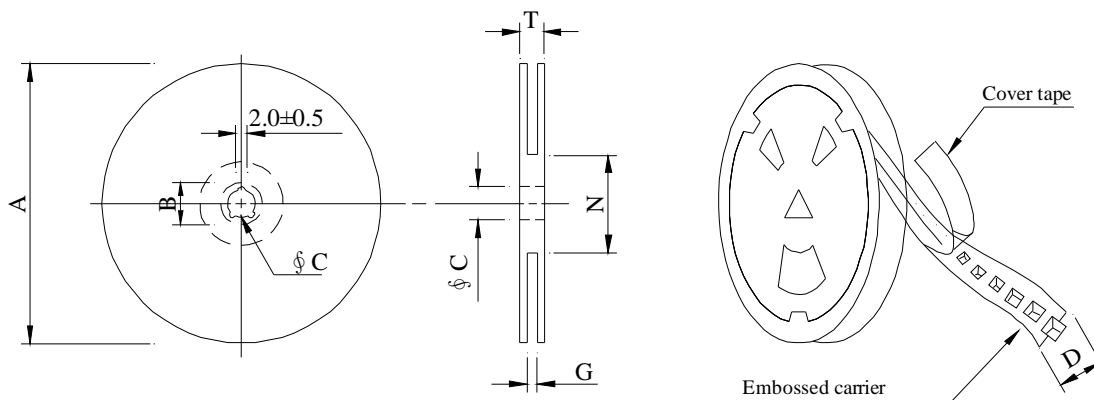

※Carrier tape width : D

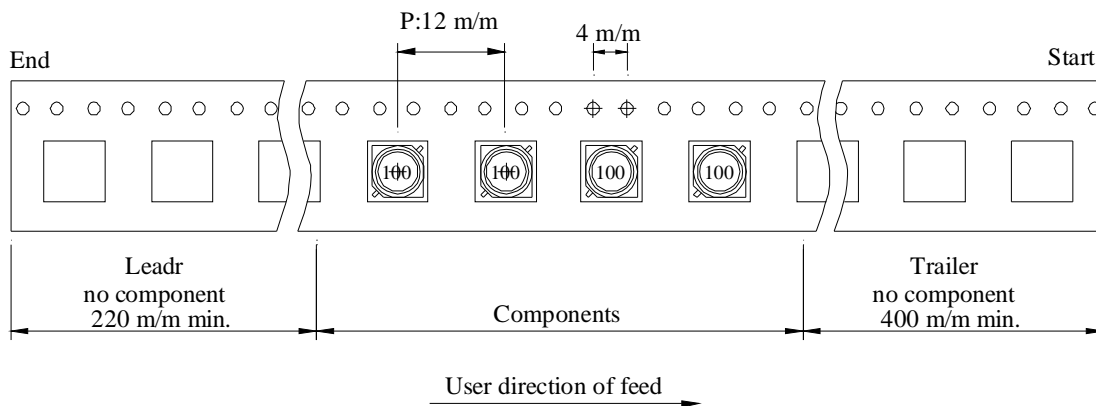

(2) Dimensions

Unit:m/m

Style	A	B	C	D	G	N	T
07 - 16	178	21±0.8	13	16	18 ⁺⁰	50 ⁻⁰	20.5
13 - 16	330	21±0.8	13±0.5	16	18 ⁺⁰	50 ⁻⁰	22.4

(3) Q'TY & G.W. Per package

Series	Inner : Reel			Outer : Carton		
	Q'TY (pcs)	G.W. (gw)	Style	Q'TY (pcs)	G.W. (Kg)	Size (cm)
SS6028	400	180	07 - 16	16,000	7.2	42 x 41 x 24
SS6028	1,500	700	13 - 16	9,000	4.2	40 x 40 x 24

AR-001A



SPECIFICATION FOR APPROVAL

REF : 20081111-B

PAGE: 4

PROD. NAME	SHIELDED SMD POWER INDUCTOR	ABC'S DWG NO.	SS6028□□□□L□-□□□
		ABC'S ITEM NO.	

VII . DWGING NUMBER EXPRESSION :

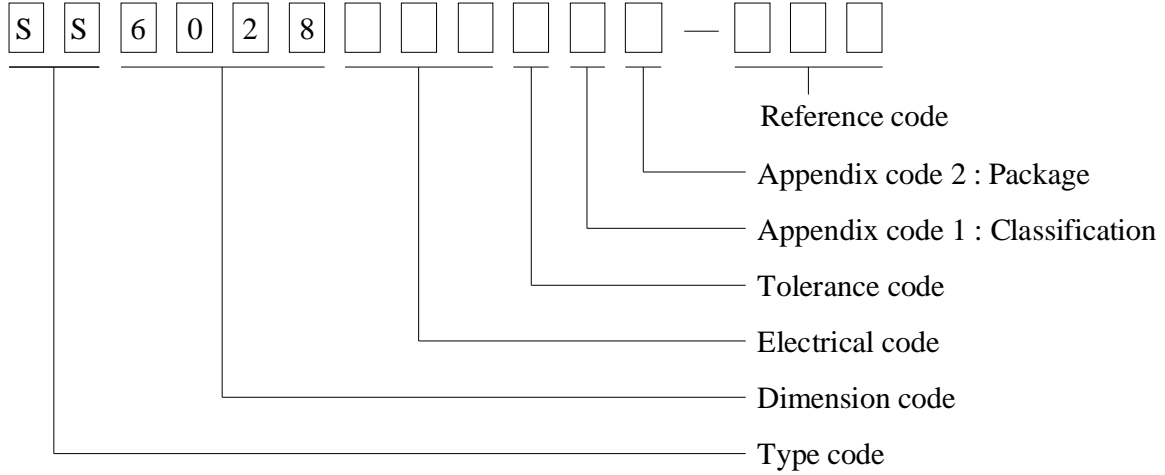

Appendix code 1 : Product Classification

- L : Lead Free Standard products comply with RoHS' requirements
- 1 ~ 9 : Lead Free Special products comply with RoHS' requirements

Appendix code 2 : Package Information

Code	Inner package	Inner package Q'TY	Remark
A	T.B.D.	T.B.D.	
B	T / R (Reel package)	400 pcs	
C	T / R (Reel package)	1500 pcs	

AR-001A



SPECIFICATION FOR APPROVAL

REF : 20081111-B

PAGE: 5

PROD. NAME	SHIELDED SMD POWER INDUCTOR	ABC'S DWG NO.	SS6028□□□□L□-□□□
		ABC'S ITEM NO.	

VIII . RELIABILITY TEST :

Test item	Specification	Test condition						
Solderability	More than 95% of the terminal electrode shall be covered With fresh solder.	Preheat : 155°C / 4 hours. Solder : Sn96.5 / Ag3 / Cu0.5 or equivalent Solder temp. : 235±5°C Flux : Rosin Dip time : 5±0.5 seconds						
Thermal shock test (Temp. cycle)	Electrical oharakteristics shall not change more than ±20%	<table style="width: 100%; border: none;"> <tr> <td style="text-align: center;">Room temp. 15 minutes</td> <td style="text-align: center;">→</td> <td style="text-align: center;">-40 °C 30 minutes</td> </tr> <tr> <td style="text-align: center;">Room temp. 15 minutes</td> <td style="text-align: center;">→</td> <td style="text-align: center;">+125 °C 30 minutes</td> </tr> </table> <p>Total : 50 cycles</p>	Room temp. 15 minutes	→	-40 °C 30 minutes	Room temp. 15 minutes	→	+125 °C 30 minutes
Room temp. 15 minutes		→	-40 °C 30 minutes					
Room temp. 15 minutes		→	+125 °C 30 minutes					
Humidity test		Temperature : 40±2°C Humidity : 90±5% Time : 1000 hours						
High temp. Resistance test	Temperature : 125±5°C Applied current : Per spec. Time : 96 hours							

AR-001A



SPECIFICATION FOR APPROVAL

REF : 20081111-B

PAGE: 7

PROD. NAME	SHIELDED SMD POWER INDUCTOR	ABC'S DWG NO.	SS6028□□□□L□-□□□
		ABC'S ITEM NO.	

		SUMITOMO CHEMICAL CO LTD						E54705 (M)				
		5-33 KITAHAMA 4-CHOME CHUO-KO, OSAKA JAPAN										
Mtl Dsg	Col	Min Thk mm	UL94 Flame Class	Elec	RTI		H W I	H A I	H V R	D 4 5	C T I	
					with Imp	Mech w/o Imp						
Liquid crystal polyester (LCP), designated "EKONOL" or "SUMIKASUPER", furnished in the form of pellets. (Contd)												
E4008, E400X	NC, BK	0.30	94V-0	130	130	130	—	—	—	—	—	
		0.75	94V-0	130	130	130	3	4	—	—	—	
		1.5	94V-0	130	130	130	2	4	—	—	—	
		3.0	94V-0	130	130	130	1	4	0	5	4	
E4008	NC, WT, BK	0.30	94V-0	130	130	130	—	—	—	—	—	
		0.75	94V-0	220	180	220	3	4	—	—	—	
		1.5	94V-0	220	200	240	2	4	—	—	—	
		3.0	94V-0	220	200	240	1	4	0	5	4	
E4010	NC, BK	0.30	94V-0	130	130	130	—	—	—	—	—	
		0.75	94V-0	220	180	220	3	4	—	—	—	
		1.5	94V-0	220	200	240	2	4	—	—	—	
		3.0	94V-0	220	200	240	1	4	0	5	4	
E400(Y)L, E4008L	NC, BK	0.30	94V-0	130	130	130	—	—	—	—	—	
		0.75	94V-0	130	130	130	3	4	—	—	—	
		1.5	94V-0	130	130	130	2	4	—	—	—	
		3.0	94V-0	130	130	130	1	4	0	5	4	
E4810	NC, BK	0.30	94V-0	130	130	130	—	—	—	—	—	
		0.75	94V-0	130	130	130	0	4	—	—	—	
		1.5	94V-0	130	130	130	0	4	—	—	—	
		3.0	94V-0	130	130	130	1	4	0	5	4	

(X) Denotes any number 1 thru 9.
(Y) Denotes any number 1 thru 7.

AR-001A

