

PRODUCT NO	WITH PICK-UP CAP	PACKAGING
10045105-001LF	NO	TRAY
10045105-001CLF	YES	TAPE & REEL
10045105-001C-TRLF		

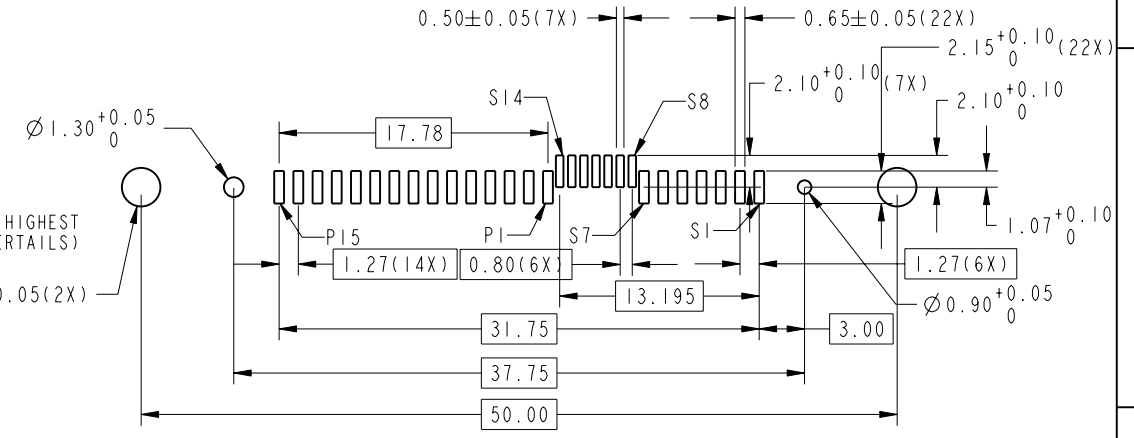
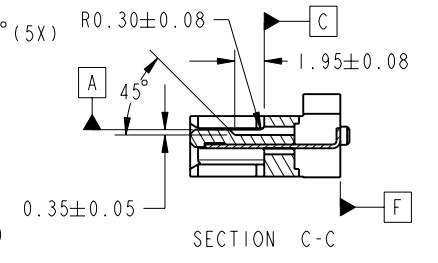
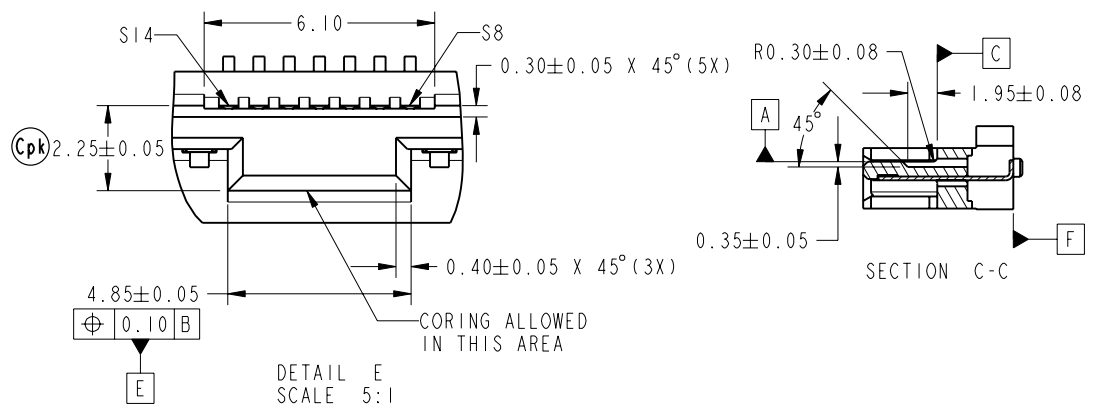
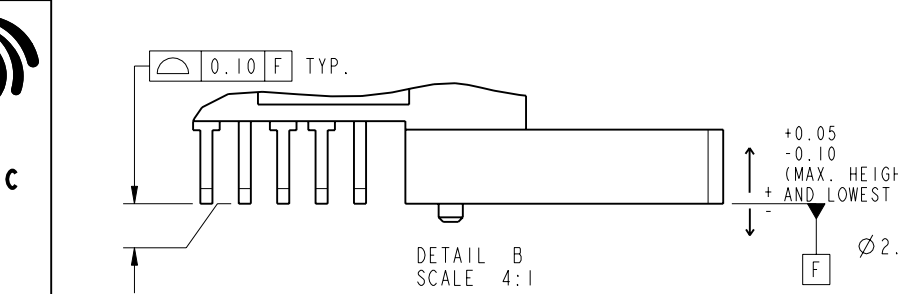
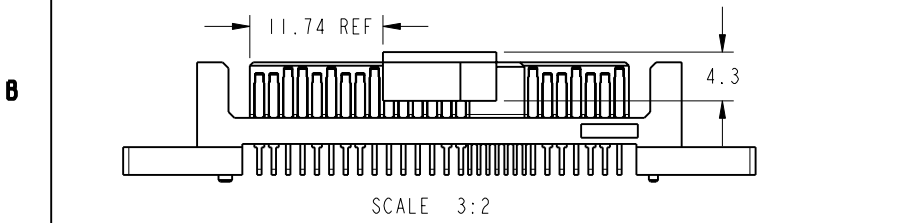
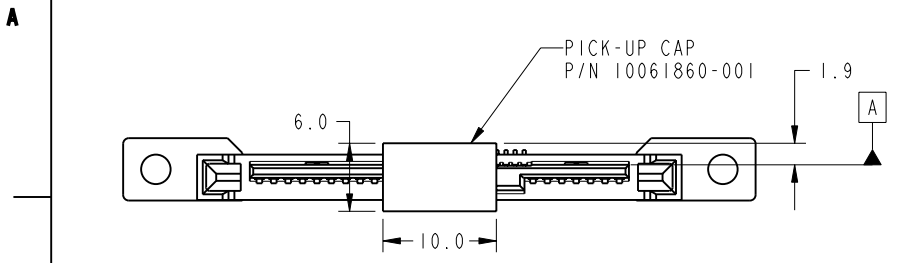

- NOTES:
- MATERIAL:
HOUSING: HIGH TEMPERATURE PLASTIC, BLACK, UL94V-0
CONTACT: COPPER ALLOY
 - FINISH:
1.27um MIN NICKEL UNDERPLATE OVERALL,
2.54um MIN TIN (LEAD-FREE) ON SOLDER TAIL,
0.76um MIN GOLD ON CONTACT AREA
 - THIS PRODUCT MEETS EUROPEAN UNION DIRECTIVES AND OTHER COUNTRY REGULATIONS AS DESCRIBED IN GS-22-008
 - THE HOUSING WILL WITHSTAND EXPOSURE TO 260°C PEAK TEMPERATURE FOR 10 SECONDS IN A CONVECTION, INFRA-RED OR VAPOR PHASE REFLOW OVEN
 - COPLANARITY FROM SEATING PLANE: 0.1mm MAX.
 - PART WITH PICK-UP CAP, P/N XXXXXXXX-XXXCLF
 - FOR TAPE & REEL PACKAGING, P/N XXXXXXXX-XXXC-TRLF
 - A SYMBOL WILL BE NEXT TO ANY DIMENSION, VIEW OR NOTE WHICH HAS BEEN MODIFIED WITH THE CURRENT DRAWING REVISION

	TITLE	SAS PLUG VERTICAL SMT ASSY	dwg no	10045105	Rev.	F
	CATALOG NO		CUSTOMER		SHEET 2 OF 2	

REV E - 2006-03-28