

# SPECIFICATION FOR APPROVAL

REF :

PAGE: 1

PROD. NAME	FILTER COIL	ABC'S DWG NO.	TR□□□□□□□□Lo-□□□
		ABC'S ITEM NO.	

. CONFIGURATION :

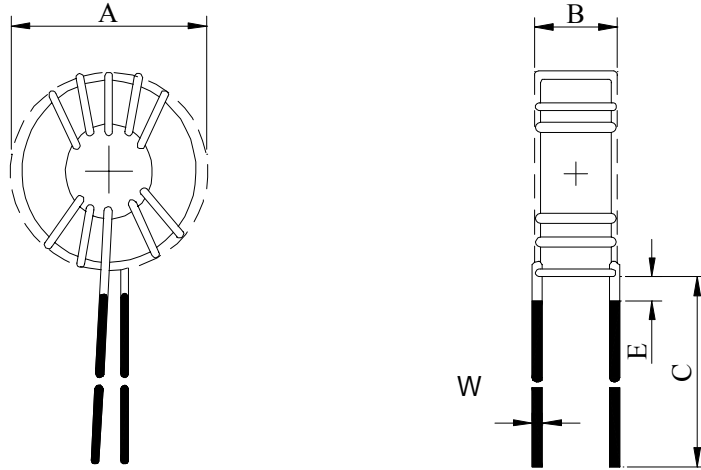

. SCHEMATIC DIAGRAM :

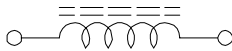

. CHARACTERISTICS OF CORE MATERIAL :

Uiac : 75

Bs : 14000 Gauss

Temperature stability : ±5 ---- 10%

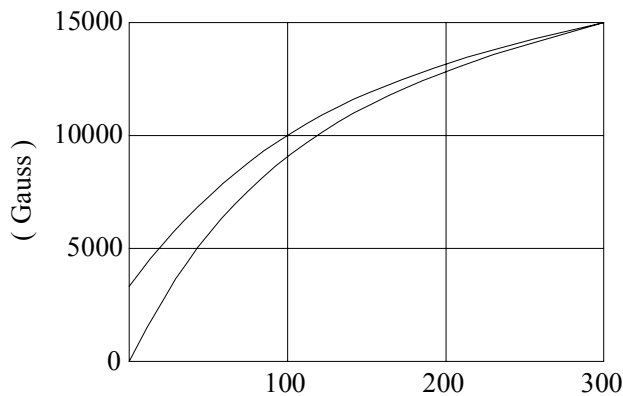

AR-001A

# SPECIFICATION FOR APPROVAL

REF :

PAGE: 2

PROD. NAME	FILTER COIL	ABC'S DWG NO.	TR□□□□□□□□L□-□□□
		ABC'S ITEM NO.	

**. MATERIALS :**

- a . Core : iron powder TR core
- b . Wire : Enamelled copper wire (class F)
- c . Remark : Products comply with RoHS' requirements

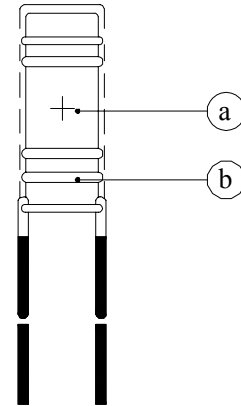

**. GENERAL SPECIFICATION :**

- a . Storage temp. : -25 --- +85
- b . Operating temp. : -20 --- +80

**. ELECTRICAL CHARACTERISTICS & MECHANICAL DIMENSIONS :**

DWG No.	Inductance ( $\mu$ H) min.	DC Resistance ( $m\Omega$ ) max.	Rated Current ( A )	Dimensions ( m/m )				
				A max.	B max.	C	E max.	W
TR0806100YL□-□□□	10	45	1	8.5	6.0	20.0 $\pm$ 5	3.0	0.4
TR1307250YL□-□□□	25	85	2	13.5	7.5	20.0 $\pm$ 5	3.0	0.4
TR1711260YL□-□□□	26	55	2	17.0	11.0	25.0 $\pm$ 5	3.0	0.6
TR1711460YL□-□□□	46	70	2	17.0	11.0	25.0 $\pm$ 5	3.0	0.6
TR1711720YL□-□□□	72	85	2	17.0	11.0	25.0 $\pm$ 5	3.0	0.6
TR1714450YL□-□□□	45	75	2	17.0	14.0	25.0 $\pm$ 5	3.0	0.6
TR1714800YL□-□□□	80	85	2	17.0	14.0	25.0 $\pm$ 5	3.0	0.6
TR1714131YL□-□□□	125	100	2	17.0	14.0	25.0 $\pm$ 5	3.0	0.6
TR2313400YL□-□□□	40	40	3	23.0	13.0	25.0 $\pm$ 5	3.0	0.8
TR2313720YL□-□□□	72	50	3	23.0	13.0	25.0 $\pm$ 5	3.0	0.8
TR2313111YL□-□□□	110	70	3	23.0	13.0	25.0 $\pm$ 5	3.0	0.8
TR2616350YL□-□□□	35	30	5	26.0	16.0	25.0 $\pm$ 5	3.0	1.0
TR2616640YL□-□□□	64	40	5	26.0	16.0	25.0 $\pm$ 5	3.0	1.0
TR2616101YL□-□□□	100	50	5	26.0	16.0	25.0 $\pm$ 5	3.0	1.0
TR3217450YL□-□□□	45	40	5	32.0	17.0	25.0 $\pm$ 3	3.0	1.0
TR3217900YL□-□□□	90	50	5	32.0	17.0	25.0 $\pm$ 3	3.0	1.0
TR3217141YL□-□□□	140	70	5	32.0	17.0	25.0 $\pm$ 3	3.0	1.0

- 1). Rated current base on temp. rise : 40 max.
- 2). "- □□□":Reference code

AR-001A



# SPECIFICATION FOR APPROVAL

REF :

PAGE: 3

PROD. NAME	FILTER COIL	ABC'S DWG NO. ABC'S ITEM NO.	TR□□□□□□□□L□-□□□
---------------	-------------	---------------------------------	------------------

**. INDUCTANCE VS. DC SUPERPOSITION CHARACTERISTICS :**

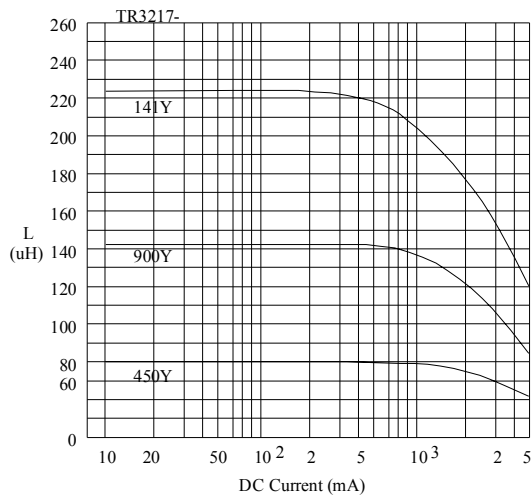
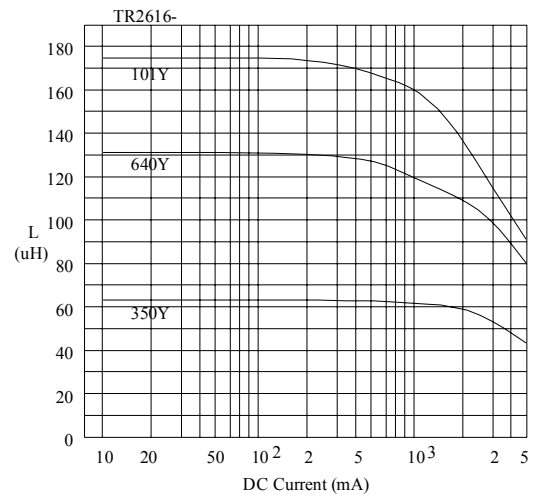
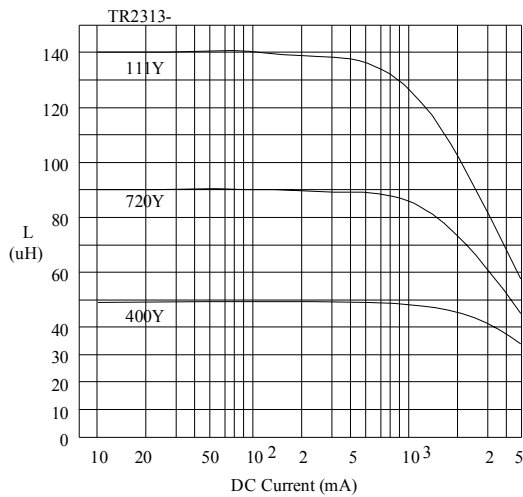
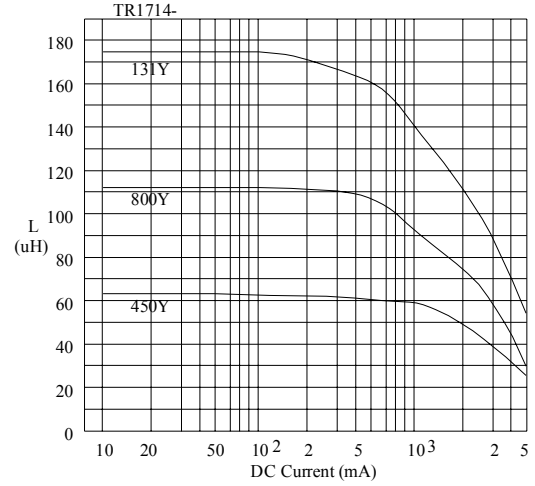
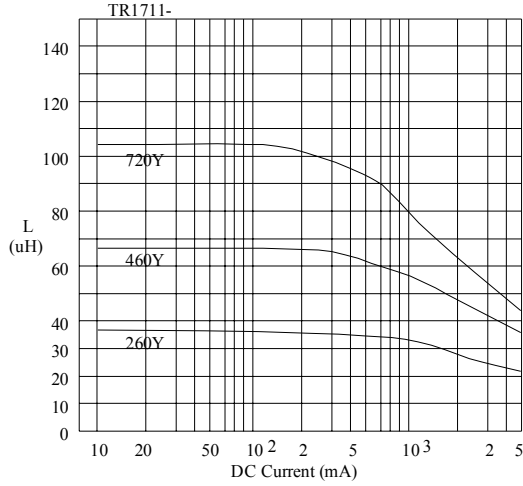

LCR Meter : Model HP4274A 0.1 V / 1 KHz

AR-001A



# SPECIFICATION FOR APPROVAL

REF :

PAGE: 4

PROD. NAME	FILTER COIL	ABC'S DWG NO.	TR□□□□□□□□L□-□□□
		ABC'S ITEM NO.	

. DWGING NUMBER EXPRESSION :

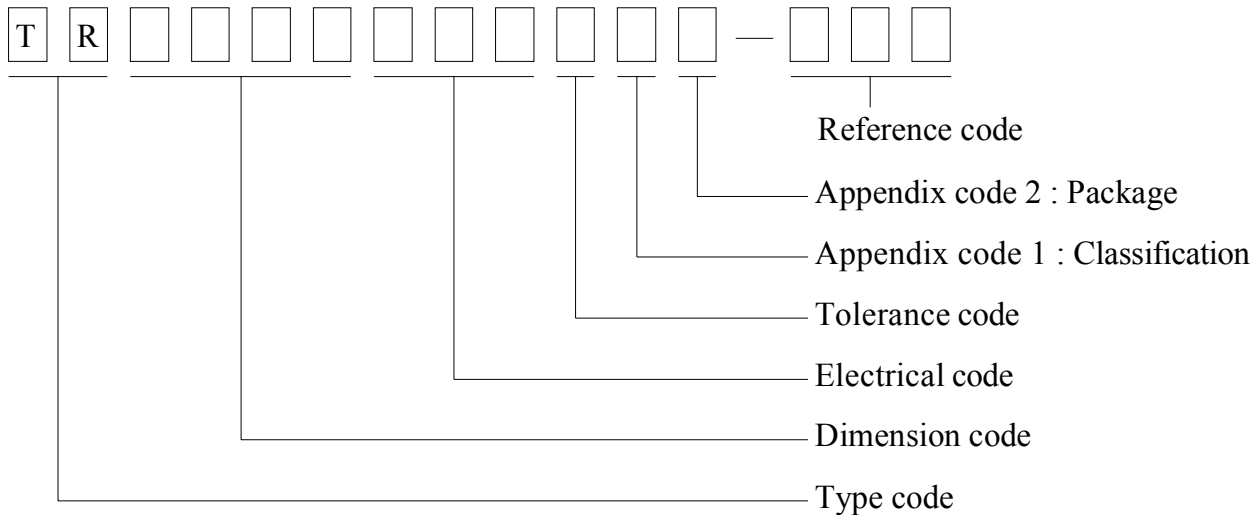

Appendix code 1 : Product Classification

- L : Lead Free Standard products comply with RoHS' requirements
- 1 ~ 9 : Lead Free Special products comply with RoHS' requirements

Appendix code 2 : Package Information

Code	Inner package	Inner packge Q'TY	Remark
A	Tray	500 pcs	TR0806
		1170 pcs	TR1307
		345 pcs	TR1711
		345 pcs	TR1714
		345 pcs	TR2313
		140 pcs	TR2616
		90 pcs	TR3217

AR-001A



# SPECIFICATION FOR APPROVAL

REF :

PAGE: 5

PROD. NAME	FILTER COIL	ABC'S DWG NO.	TR□□□□□□□□L□-□□□
		ABC'S ITEM NO.	

UL CARD :

OBMW2		September 8, 2000				
Magnet Wire-Component						
JUNG SHING WIRE CO LTD				E174837		
231 CHUNG CHENG RD, SEC 3 JEN-TEH HSIANG, TAINAN						
HSIEN TAIWAN						
Mtl Dsg	Mark Dsg	BC	Coat Typ	OC	ANSI Type	Temp Class
AIW	---	Polyamideimide	---	---	MW81-C	220
CFUEWB	---	Polyurethane	---	---	MW75C	130
EIAIW	---	Polyesterimide	Polyamideimide	---	MW35C	200
EILOCKY	---	Polyesterimide	Polyamide	---	---	180
EILOCKW	---	Polyesterimide	Modified Epoxy	---	---	200
EIW	---	Polyesterimide	---	---	---	220
EIW-2	---	Polyesterimide	---	---	MW74-C	200
FL.EILOCKY	---	Modified Polyester	Polyamide	---	---	155
LFFFW	---	Polyurethane	---	---	MW79-C	155
LSUEW	---	Polyurethane	---	---	---	130
PEW	---	Polyester	---	---	---	155
PEY	---	Polyester	Nylon	---	MW24-C	155
SF.FLW	---	Modified Polyester	---	---	MW26C	155
SF.EIW	---	Polyesterimide	---	---	MW77C	180
SF.BY@	---	Modified Polyester	Nylon	---	MW27-C	155
SF.FLY@	---	Modified Polyester	Nylon	---	MW27-C	155
SF.BLOCKBS	---	Modified Polyester	Modified Polyamide	---	---	155
SF.EILOCKY#	---	Polyesterimide	Polyamide	---	---	180
SF.EILOCKBS	---	Polyesterimide	Modified Polyamide	---	---	180
SF.BW@	---	Modified Polyester	Polyamide	---	MW26C	155
SFFFW	---	Polyurethane	---	---	MW79	155
287806002		Page 1 of 2		A not-for-profit organization dedicated to public safety and committed to quality service		
Mtl Dsg	Mark Dsg	BC	Coat Typ	OC	ANSI Type	Temp Class
SFFY	---	Polyurethane	Polyamide	---	MW80C	155
UEW-1	---	Polyurethane	---	---	MW2-C	105
UEW-2	---	Polyurethane	---	---	---	130
UEW-4	---	Polyurethane	---	---	MW75C	130
UEY	---	Polyurethane	Nylon	---	MW28-C	130
UEY-2	---	Polyurethane	Polyamide	---	MW28-C	130
@-May be suffixed by LZ; # - May be suffixed by LZ, EL or LZI. LZ - Signifies magnd wires twisted together; EL - signifies base coated magnet wire laid parallel with top coat applied overall; LZL - signifies base coated magnet wire twisted together and covered with top coat overall. Marking: Company name or trademarks <b>JSW</b> or 榮星電線 , material designation or marked designation on packaed or reel, and Recognized Component Mark. See General Information Preceding These Recognitions For use only in equipment where the acceptability of the combination is determined by Underwriters Laboratories Inc.						
287806002		Page 2 of 2		OBMW2E174837 September 8, 2000		

AR-001A



千如電子集團  
ABC ELECTRONICS GROUP.