



SWE61000(6V100AH)



Specifications

Nominal Voltage		6V
Rated capacity (10 hour rate)		100 Ah
Dimensions	Total Height	211 mm (8.31 inches)
	Height	206 mm (8.11 inches)
	Length	195 mm (7.67 inches)
	Width	170mm (6.69 inches)
Weight Approx		17Kg (37.57 lbs)

Characteristics

Capacity 25°C(77°F)	10 hour rate(10.0A) 5 hour rate(16.0A) 1 hour rate(60.0A)	100 AH 80 AH 60 AH
Internal Resistance	Full charged Battery at 25°C(77°F)	Approx 2.3 mΩ
Capacity affected by Temperature (10hour rate)	40°C(104°F) 25°C(77°F) 0°C(32°F) -15°C(5°F)	102% 100% 85% 65%
Self-Discharge at 25°C(77°F)	Capacity after 3 month storage Capacity after 6 month storage Capacity after 12 month storage	91% 82% 64%
Terminal	T16	
Charge (constant Voltage)	Cycle	Initial Charging Current less than 40 A Voltage 7.05-7.2V
	Float	Voltage 6.75-6.90V

Outer dimensions (mm)

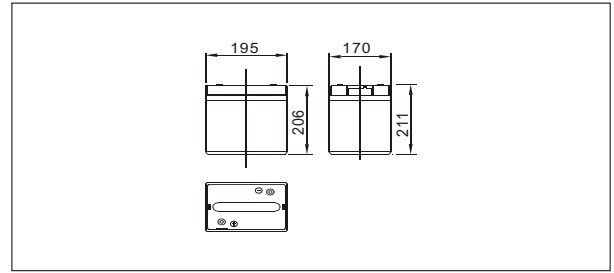

Terminal Type (mm)

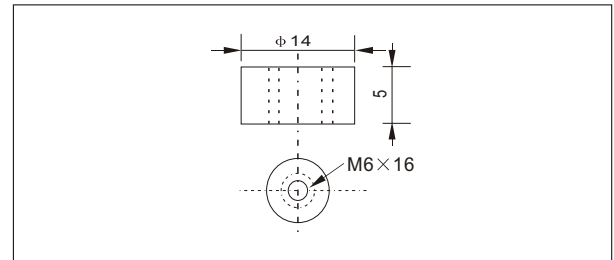

Curves of cycle life(25°C)

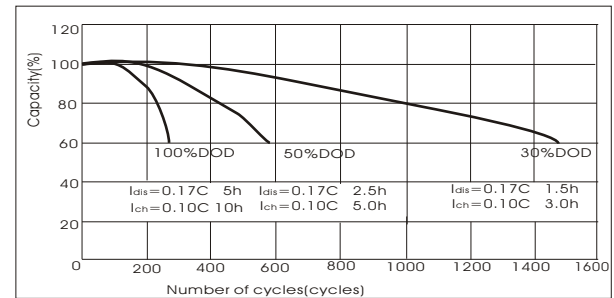

Discharge Curves 25°C(77°F)

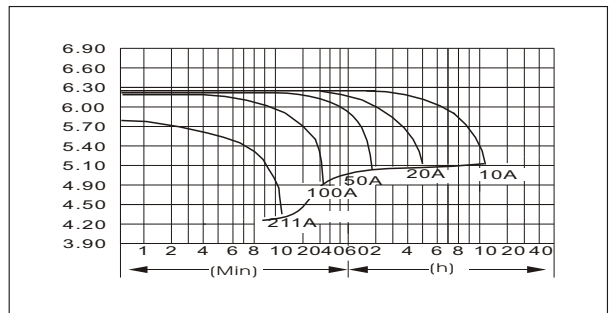

Constant Current(Amp) and Constant Power(Watt) Discharge Table at 25°C(77°F)

Time		5min	10min	15min	30min	1h	2h	3h	4h	5h	8h	10h	20h
4.80V	A	320	211	170	114	60	35.0	25.7	20.0	16.5	11.7	10.5	5.7
	W	1653	1127	912	613	324	192.2	143.0	112.5	93.8	67.0	60.6	33.0
5.10V	A	310	190	160	109	56	33.4	25.0	19.5	16.2	11.4	10.3	5.5
	W	1656	1063	896	612	319	192.5	144.8	113.4	94.4	66.7	60.5	32.3
5.25V	A	300	170	140	102	55	32.6	24.4	19.2	16.0	11.3	10.1	5.5
	W	1639	969	799	587	316	189.0	142.2	112.3	93.8	66.4	59.8	32.5
5.40V	A	289	161	130	94	53	31.8	23.8	18.9	15.6	11.0	10.0	5.4
	W	1622	925	750	545	307	186.2	140.3	111.6	92.2	65.2	59.4	32.2
5.55V	A	280	150	120	84	51	31.0	23.0	18.4	15.2	10.7	9.5	5.1
	W	1585	871	700	491	300	183.2	136.6	109.6	90.7	64.1	57.3	30.9