

## TERMINAL BLOCKS

- 7.5mm Pitch
- Rising Clamp Terminal
- 2 - 12 pole interlocking
- 2.5mm<sup>2</sup> wire acceptance
- UL/CE/VDE approved
- Colour green

## 7.5MM PITCH 18 POLE RISING CLAMP

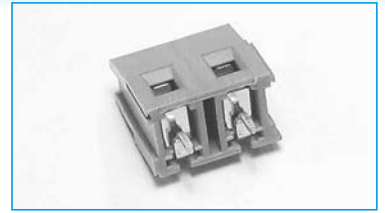

### SPECIFICATION

#### Electrical Characteristics

**Rating Current:** 20A/750V  
**Dielectric Voltage:**  $\geq 3\text{kV}/60\text{sec}$   
**Insulation Resistance:**  $\geq 5\text{M}\Omega$   
**Operating Temperature:** -20°C to +125°C  
**Short Period:** 160°C

**Moulding:** UL94-V0 flame retardant PA66  
**Pin/terminal:** 5 $\mu$  tinned, nickel plated brass  
**Wire clamp:** Nickel plated brass  
**Screw/torque:** M3 steel, 6 $\mu$  zinc colour passivated and tropicalised/0.5Nm  
**Recommended PCB hole size:**  $\varnothing 1.3\text{mm}$

### OUTLINE DRAWING

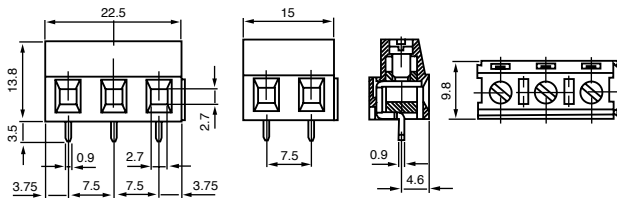

### ORDERING INFORMATION

DBC	TB	33	/2
Dubilier Connectors	Series Terminal Blocks	Style	No of Ways
			2 = 2ways 3 = 3ways
* other number of ways are available Please consult the office for further details			

## TERMINAL BLOCKS

- 7.5mm pitch
- Flame retardant material
- 2.5mm<sup>2</sup> wire acceptance
- Interlocking
- Professional rising clamp
- UL/ CSA approved



## 7.5mm PITCH 90° MOUNT



### SPECIFICATION

**Rating:** 20A/750V  
**Dielectric Strength:**  $\geq 3\text{KV}/60\text{sec}$   
**Insulation Resistance:**  $\geq 5\text{M}\Omega$   
**Working temperature:** -20°C to 125°C  
**Short Period:** 160°  
**Moulding:** UL94V-0 flame retardant PA66  
**Pin/terminal:** 5 $\mu$  tinned, nickel plated brass

**Wire clamp:** Nickel plated brass  
**Screw/torque:** M3 steel, 6  $\mu$  zinc colour passivated and tropicalised/0.5Nm  
**Recommended PCB hole size:**  $\varnothing 1.3\text{mm}$

### OUTLINE DRAWING

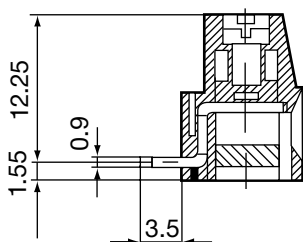

### ORDERING INFORMATION

DBC	TB	88	/2
Dubilier Connectors	Series Terminal Block	Style	Nº of Ways
			2 = 2 ways 3 = 3 ways
* Other Number of ways are available up to 12 Please consult office for further details			

SECTION 18