

## Schematic:

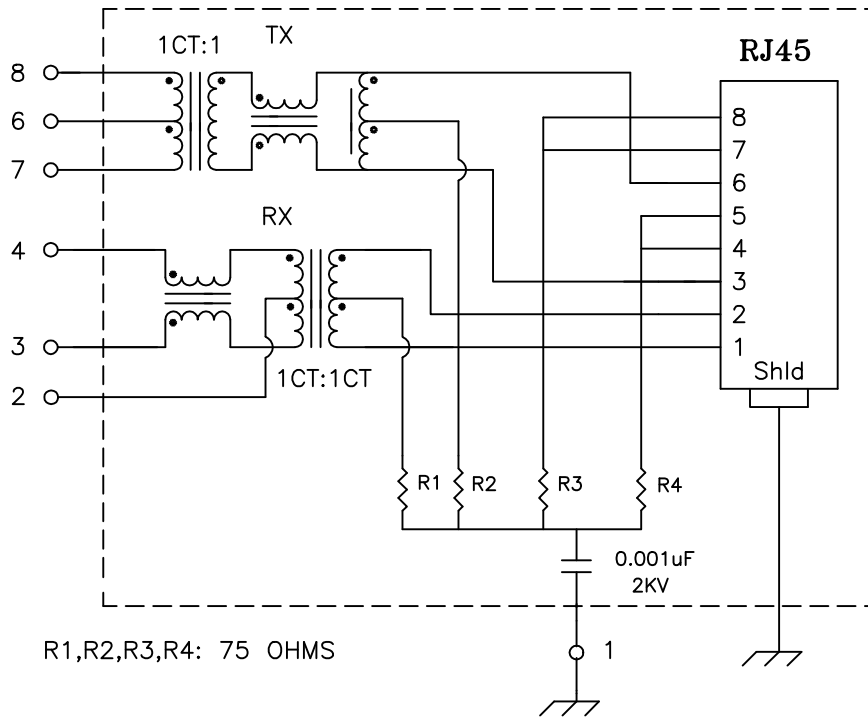

## Electrical Specifications: @25°C

Isolation Voltage: 1500 Vrms (INPUT to OUTPUT)

Isolation Voltage: 500 Vrms (6+7+8-2+3+4)

TURNS RATIO: TX 1CT:1 ±5% RX 1CT:1CT ±5%

OCL: 350uH Minimum @100KHz 100mV 8mADC

Insertion Loss (300KHz-100MHz): -1.0dB Typical

Return Loss: 30MHz -16dB Typical

60MHz -12dB Typical

80MHz -10dB Typical

CROSSTALK: 32MHz -40dB Minimum

62MHz -35dB Minimum

100MHz -35dB Minimum

### Note:

1. Solderability: Leads shall meet MIL-STD-202, Method 208D for solderability.
2. Flammability: UL94V-0,
3. ASTM oxygen index: > 28% ,
4. Temperature rating: 155°C. UL file E151556,
5. Operating Temperature Range: All listed parameters are to be within tolerance from -40°C to +85°C

**XFMRS Inc.**

Title: **SINGLE PORT COMBO**

UNLESS OTHERWISE SPECIFIED  
TOLERANCES:  
.xxx ±0.010  
Dimensions in Inch  
SHEET 1 OF 2

P/N:	XFATM6-COMBO1-4MS	REV.	B
DWN.	廖玉坤	Jul-23-01	
CHK.	李清儿	Jul-23-01	
APP.	BW	Jul-23-01	

DOC. REV: B/1

**Mechanical Dimensions:**

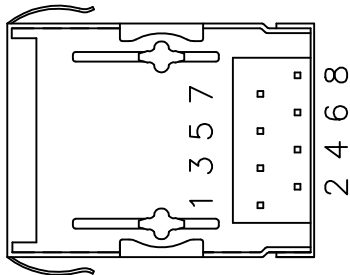
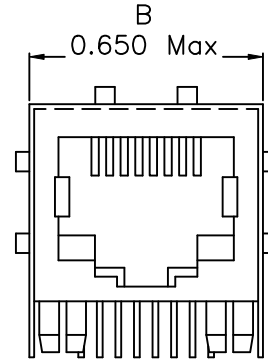
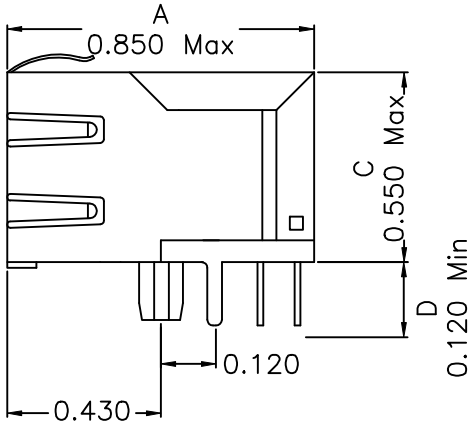
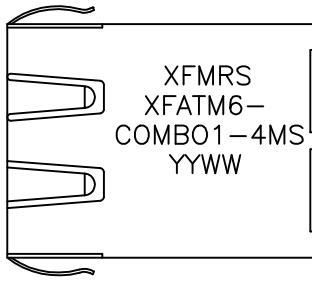

(BOTTOM VIEW)

**Mounting Pattern:**

(FOR COMBO1-4MS)  
(COMP SIDE)

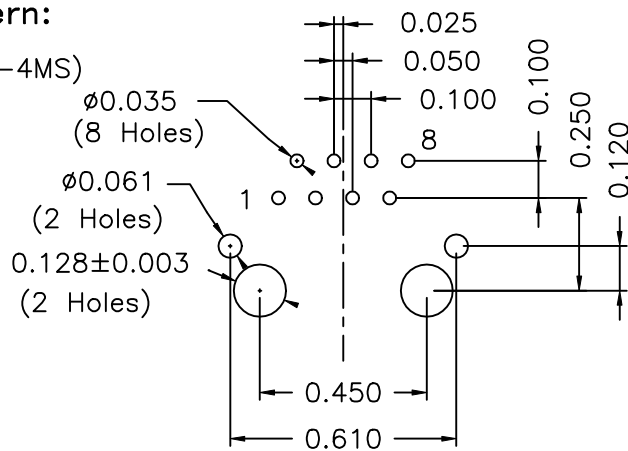

<b>XFMR5 Inc.</b>	Title: Mechanical Dimensions For COMBO1-4MS Series	
UNLESS OTHERWISE SPECIFIED TOLERANCES: .xxx ±0.010 Dimensions in Inch	P/N: XFATM6-COMBO1-4MS	REV. B
	DWN.	李小锋 Jun-23-01
	CHK.	廖玉坤 Jun-23-01
SHEET 2 OF 2	APP.	BW Jun-23-01