

Aluminum Capacitors Power High Ripple Current Screw Terminals

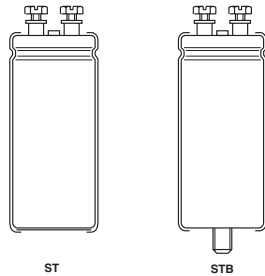

Fig.1 Component outline

FEATURES

- Polarized aluminum electrolytic capacitors, non-solid electrolyte
- Large types, cylindrical aluminum case, insulated with a blue sleeve
- Pressure relief in the sealing
- Long useful life



RoHS
COMPLIANT

APPLICATIONS

- Computer, telecommunications and industrial systems
- Smoothing and filtering
- Standard and switched mode power supplies

MARKING

The capacitors are marked with the following information:

- Rated capacitance (in μF)
- Tolerance on rated capacitance, code letter in accordance with IEC 60062 (M for $\pm 20\%$)
- Rated voltage (in V)
- Date code (YYMM)
- Name of manufacturer
- Code for factory of origin
- '-' sign to identify the negative terminal, visible from the top and side of the capacitor
- Code number
- Climatic category in accordance with IEC 60068

| QUICK REFERENCE DATA | | |
|---|--|--------------|
| DESCRIPTION | VALUE | |
| | 101 | 102 |
| Nominal case size ($\varnothing D \times L$ in mm) | 35 x 60 to 76 x 146 | |
| Rated capacitance range (E6 series), C_R | 220 to 330000 μF | |
| Tolerance on C_R | $\pm 20\%$ | |
| Rated voltage range, U_R | 25 to 100 V | 200 to 450 V |
| Category temperature range | - 40 to + 85 °C | |
| Endurance test at 85 °C | 2000 hours | |
| Useful life at 85 °C | 10000 hours ($D \leq 50$ mm) 15000 hours ($D \geq 65$ mm) | 10000 hours |
| Useful life at 40 °C, 1.4 x I_R applied | 400000 hours ($D \leq 50$ mm) 600000 hours ($D \geq 65$ mm) | 400000 hours |
| Shelf life at 0 V, 85 °C | 500 hours | |
| Based on sectional specification | IEC 60 384-4/EN130300 | |
| Climatic category IEC 60068 | 40/085/56 | |

| SELECTION CHART FOR C_R , U_R AND RELEVANT NOMINAL CASE SIZES ($\varnothing D \times L$ in mm) | | | | | | | | | | |
|---|-----------|----|---------|---------|----------|----------|----------|----------|----------|----------|
| C_R (μF) | U_R (V) | | | | | | | | | |
| | 25 | 40 | 63 | 100 | 200 | 250 | 350 | 385 | 400 | 450 |
| 220 | - | - | - | - | - | - | - | 35 x 60 | 35 x 60 | 35 x 60 |
| 330 | - | - | - | - | - | - | 35 x 60 | - | 35 x 60 | - |
| 470 | - | - | - | - | - | - | - | 35 x 80 | 35 x 80 | 35 x 80 |
| | - | - | - | - | - | 35 x 60 | - | 35 x 80 | 35 x 80 | - |
| 680 | - | - | - | - | - | - | 35 x 80 | - | 35 x 105 | 35 x 105 |
| | - | - | - | - | 35 x 60 | 35 x 80 | - | 35 x 105 | 35 x 105 | - |
| 1000 | - | - | - | - | - | - | 35 x 105 | - | 50 x 80 | 50 x 80 |
| | - | - | - | - | 35 x 80 | 35 x 80 | - | 50 x 80 | 50 x 80 | 50 x 80 |
| 1500 | - | - | - | - | - | - | 50 x 80 | - | 50 x 105 | 50 x 105 |
| | - | - | - | - | 35 x 105 | 35 x 105 | - | - | - | 50 x 105 |
| 2200 | - | - | - | - | - | - | 50 x 105 | - | 50 x 105 | 50 x 105 |
| | - | - | - | 35 x 60 | 50 x 80 | 50 x 80 | 50 x 105 | - | - | 65 x 105 |
| 3300 | - | - | - | - | - | - | 50 x 105 | 65 x 105 | 65 x 105 | 65 x 105 |
| | - | - | - | 35 x 60 | 50 x 80 | 50 x 105 | - | - | 65 x 105 | 76 x 105 |
| 4700 | - | - | - | - | - | - | 65 x 105 | 65 x 105 | 76 x 105 | 76 x 105 |
| | - | - | 35 x 60 | 35 x 80 | - | 65 x 105 | 76 x 105 | 76 x 105 | 76 x 105 | 76 x 146 |
| 5600 | - | - | - | - | - | - | 76 x 105 | 76 x 105 | 76 x 146 | 76 x 146 |
| | - | - | - | - | - | - | - | - | 76 x 146 | 76 x 146 |

| SELECTION CHART FOR C_R, U_R AND RELEVANT NOMINAL CASE SIZES (∅ D × L in mm) | | | | | | | | | | |
|---|--------------------|----------|----------|----------|----------|----------|----------|----------|----------|-----|
| C _R (μF) | U _R (V) | | | | | | | | | |
| | 25 | 40 | 63 | 100 | 200 | 250 | 350 | 385 | 400 | 450 |
| 6800 | - | - | 35 x 60 | 35 x 105 | 65 x 105 | 76 x 105 | - | - | - | - |
| | - | - | 35 x 80 | 50 x 80 | 76 x 105 | 76 x 146 | 76 x 146 | 76 x 146 | 76 x 146 | - |
| 10000 | - | 35 x 60 | 35 x 80 | 50 x 80 | 76 x 105 | 76 x 105 | - | - | - | - |
| | - | - | 35 x 105 | 50 x 105 | 76 x 146 | 76 x 146 | - | - | - | - |
| 15000 | 35 x 60 | 35 x 60 | 35 x 105 | 50 x 105 | 76 x 146 | - | - | - | - | - |
| | - | 35 x 80 | 50 x 80 | - | - | - | - | - | - | - |
| 22000 | 35 x 60 | 35 x 80 | 50 x 80 | 65 x 105 | - | - | - | - | - | - |
| | - | 50 x 80 | 50 x 105 | 76 x 105 | - | - | - | - | - | - |
| 33000 | 35 x 80 | 35 x 105 | 50 x 105 | 76 x 105 | - | - | - | - | - | - |
| | 50 x 80 | 50 x 80 | 65 x 105 | 76 x 146 | - | - | - | - | - | - |
| 47000 | 35 x 105 | 50 x 80 | 65 x 105 | - | - | - | - | - | - | - |
| | 50 x 80 | 50 x 105 | 76 x 105 | 76 x 146 | - | - | - | - | - | - |
| 68000 | 50 x 80 | 50 x 105 | 65 x 105 | - | - | - | - | - | - | - |
| | 50 x 105 | 65 x 105 | 76 x 146 | - | - | - | - | - | - | - |
| 100000 | 50 x 105 | 65 x 105 | - | - | - | - | - | - | - | - |
| | 65 x 105 | 76 x 105 | 76 x 146 | - | - | - | - | - | - | - |
| 150000 | 65 x 105 | 76 x 105 | - | - | - | - | - | - | - | - |
| | 76 x 105 | 76 x 146 | - | - | - | - | - | - | - | - |
| 220000 | 65 x 105 | - | - | - | - | - | - | - | - | - |
| | 76 x 105 | 76 x 146 | - | - | - | - | - | - | - | - |
| 330000 | 76 x 146 | - | - | - | - | - | - | - | - | - |

DIMENSIONS in millimeters AND AVAILABLE FORMS

Fig.2 Screw terminal (ST); screw terminal bolt (STB)

Maximum permissible torque which may be applied to the termination screws: 2 Nm.
 For accessories refer to datasheet "Mounting Accessories".
 The capacitors are delivered with screws and washers.

Table 1

| DIMENSIONS in millimeters, MASS AND PACKAGING QUANTITIES | | | | | | | | | | |
|---|--------------------|------------------|---------|---------|----------------------|---------|--------------------|----------|--------------------------------|------------------------------------|
| NOMINAL CASE SIZE ∅ D × L | ∅ D _{max} | L _{max} | P ± 0.3 | A ± 0.5 | d ₁ ± 0.2 | T ± 0.5 | d ₂ × l | MASS (g) | PACKAGING QUANTITIES (per box) | CARDBOARD BOX DIMENSIONS L × W × H |
| 35 × 60 | 36 | 63 | 13 | 8 | 8 | 5.9 | M8 × 12 | 75 | 25 | 196 × 192 × 110 |
| 35 × 80 | 36 | 81 | 13 | 8 | 8 | 5.9 | M8 × 12 | 95 | 25 | 196 × 192 × 115 |
| 35 × 105 | 36 | 105 | 13 | 8 | 8 | 5.9 | M8 × 12 | 130 | 25 | 196 × 192 × 140 |
| 50 × 80 | 51.5 | 83 | 22 | 12 | 8 | 5.9 | M12 × 16 | 200 | 25 | 293 × 273 × 115 |
| 50 × 105 | 51.5 | 105 | 22 | 12 | 8 | 5.9 | M12 × 16 | 300 | 25 | 293 × 273 × 140 |
| 65 × 105 | 66 | 105 | 28.5 | 16 | 8* | 5.9* | M12 × 16 | 480 | 10 | 368 × 151 × 140 |
| 76 × 105 | 77 | 106 | 32 | 19 | 8* | 5.9* | M12 × 16 | 700 | 10 | 418 × 173 × 140 |
| 76 × 146 | 77 | 146 | 32 | 19 | 8* | 5.9* | M12 × 16 | 1000 | 10 | 418 × 173 × 180 |

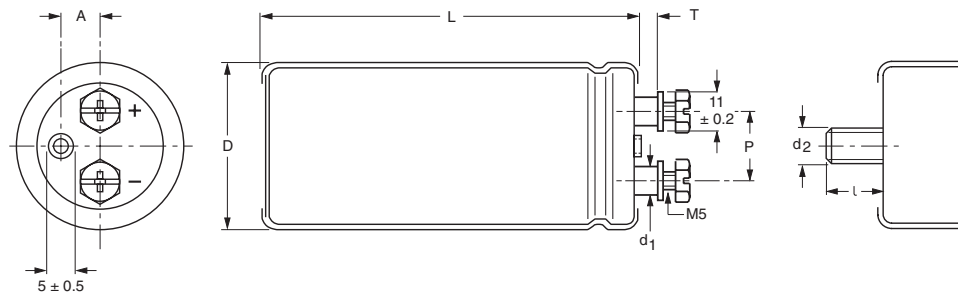
* Terminals also available in High Current version. Contact manufacturer for mechanical dimensions.

| ELECTRICAL DATA | |
|-----------------|---|
| SYMBOL | DESCRIPTION |
| C_R | rated capacitance at 100 Hz, tolerance $\pm 20\%$ |
| I_R | rated RMS ripple current at 100 Hz, 85 °C |
| I_{L5} | max. leakage current after 5 minutes at U_R |
| ESR | max. equivalent series resistance at 100 Hz |
| Z | max. impedance at 20 kHz |

ORDERING EXAMPLE

Electrolytic capacitor 101 series

10000 $\mu\text{F}/40\text{ V}$; $\pm 20\%$

Nominal case size: $\varnothing 35 \times 60\text{ mm}$;
ST version, high post M5 disc

Catalog number: 2222 101 17103.

Note

- Unless otherwise specified, all electrical values in Tables 2 and 3 apply at $T_{\text{amb}} = 20\text{ °C}$, $P = 86\text{ to }106\text{ kPa}$, $\text{RH} = 45\text{ to }75\%$.

Table 2

| ELECTRICAL DATA AND ORDERING INFORMATION FOR 101 SERIES | | | | | | | | |
|---|--------------------------------------|--|---------------------------------|---------------------------|------------------------------------|--------------------------------------|--|---|
| U_R (V) | C_R 100 Hz (μF) | NOMINAL CASE SIZE $\varnothing D \times L$ (mm) | I_R 100 Hz 85 °C (A) | I_{L5} 5 min (mA) | ESR max 100 Hz (m Ω) | Z MAX. 20 kHz (m Ω) | HIGH POST M5 DISC | |
| | | | | | | | CATALOG NUMBER ST 2222 101 | CATALOG NUMBER STB 2222 101 |
| 25 | 15000 | 35 x 60 | 7.7 | 0.75 | 29 | 22 | 16153 | 56153 |
| | 22000 | 35 x 60 | 8.3 | 1.10 | 27 | 22 | 16223 | 56223 |
| | 33000 | 35 x 80 | 9.0 | 1.65 | 19 | 17 | 16333 | 56333 |
| | 33000 | 50 x 80 | 10.0 | 1.65 | 17 | 14 | 26333 | 66333 |
| | 47000 | 35 x 105 | 12.1 | 2.35 | 15 | 13 | 16473 | 56473 |
| | 47000 | 50 x 80 | 14.8 | 2.35 | 12 | 10 | 26473 | 66473 |
| | 68000 | 50 x 80 | 12.8 | 3.40 | 15 | 13 | 16683 | 56683 |
| | 68000 | 50 x 105 | 17.1 | 3.40 | 9 | 8 | 26683 | 66683 |
| | 100000 | 50 x 105 | 14.7 | 5.00 | 12 | 11 | 16104 | 56104 |
| | 100000 | 65 x 105 | 19.6 | 5.00 | 7 | 6 | 26104 | 66104 |
| | 150000 | 65 x 105 | 17.6 | 7.50 | 8 | 7 | 16154 | 56154 |
| | 150000 | 76 x 105 | 21.4 | 7.50 | 6 | 5 | 26154 | 66154 |
| | 220000 | 65 x 105 | 20.2 | 11.00 | 6 | 5 | 16224 | 56224 |
| | 220000 | 76 x 105 | 22.5 | 11.00 | 6 | 5 | 26224 | 66224 |
| | 330000 | 76 x 146 | 25.8 | 16.50 | 4 | 4 | 26334 | 66334 |
| 40 | 10000 | 35 x 60 | 7.1 | 0.80 | 31 | 23 | 17103 | 57103 |
| | 15000 | 35 x 60 | 7.8 | 1.20 | 28 | 22 | 17153 | 57153 |
| | 15000 | 35 x 80 | 8.7 | 1.20 | 22 | 17 | 27153 | 67153 |
| | 22000 | 35 x 80 | 9.4 | 1.76 | 20 | 17 | 17223 | 57223 |
| | 22000 | 50 x 80 | 11.2 | 1.76 | 19 | 15 | 27223 | 67223 |
| | 33000 | 35 x 105 | 11.0 | 2.64 | 15 | 13 | 17333 | 57333 |
| | 33000 | 50 x 80 | 13.7 | 2.64 | 13 | 10 | 27333 | 67333 |
| | 47000 | 50 x 80 | 14.6 | 3.76 | 12 | 10 | 17473 | 57473 |
| | 47000 | 50 x 105 | 15.9 | 3.76 | 10 | 8 | 27473 | 67473 |
| | 68000 | 50 x 105 | 16.9 | 5.44 | 9 | 8 | 17683 | 57683 |
| | 68000 | 65 x 105 | 18.1 | 5.44 | 7 | 6 | 27683 | 67683 |
| | 100000 | 65 x 105 | 19.2 | 8.00 | 7 | 6 | 17104 | 57104 |
| | 100000 | 76 x 105 | 21.3 | 8.00 | 7 | 6 | 27104 | 67104 |
| | 150000 | 76 x 105 | 20.5 | 12.00 | 7 | 6 | 17154 | 57154 |
| | 150000 | 76 x 146 | 24.0 | 12.00 | 5 | 5 | 27154 | 67154 |
| | 220000 | 76 x 146 | 24.5 | 17.60 | 5 | 5 | 27224 | 67224 |



Aluminum Capacitors
Power High Ripple Current Screw Terminals

Vishay BCcomponents

| ELECTRICAL DATA AND ORDERING INFORMATION FOR 101 SERIES | | | | | | | | |
|---|----------------------------------|---|--|----------------------------------|---------------------------|-----------------------------|--|---|
| U _R (V) | C _R 100 Hz (μF) | NOMINAL CASE SIZE ∅ D × L (mm) | I _R 100 Hz 85 °C (A) | I _{L5} 5 min (mA) | ESR max 100 Hz (mΩ) | Z MAX. 20 kHz (mΩ) | HIGH POST M5 DISC | |
| | | | | | | | CATALOG NUMBER ST 2222 101 | CATALOG NUMBER STB 2222 101 |
| 63 | 4700 | 35 x 60 | 5.9 | 0.59 | 42 | 25 | 18472 | 58472 |
| | 6800 | 35 x 60 | 6.6 | 0.86 | 38 | 25 | 18682 | 58682 |
| | 6800 | 35 x 80 | 7.3 | 0.86 | 30 | 19 | 28682 | 68682 |
| | 10000 | 35 x 80 | 8.1 | 1.26 | 27 | 19 | 18103 | 58103 |
| | 10000 | 35 x 105 | 8.8 | 1.26 | 22 | 14 | 28103 | 68103 |
| | 15000 | 35 x 105 | 9.7 | 1.89 | 19 | 14 | 18153 | 58153 |
| | 15000 | 50 x 80 | 12.1 | 1.89 | 16 | 11 | 28153 | 68153 |
| | 22000 | 50 x 80 | 11.1 | 2.77 | 19 | 15 | 18223 | 58223 |
| | 22000 | 50 x 105 | 14.3 | 2.77 | 12 | 9 | 28223 | 68223 |
| | 33000 | 50 x 105 | 12.9 | 4.16 | 14 | 12 | 18333 | 58333 |
| | 33000 | 65 x 105 | 16.5 | 4.16 | 9 | 6 | 28333 | 68333 |
| | 47000 | 65 x 105 | 15.6 | 5.92 | 10 | 8 | 18473 | 58473 |
| | 47000 | 76 x 105 | 18.6 | 5.92 | 8 | 6 | 28473 | 68473 |
| | 68000 | 76 x 105 | 20.0 | 8.57 | 7 | 6 | 18683 | 58683 |
| | 68000 | 76 x 146 | 21.9 | 8.57 | 6 | 5 | 28683 | 68683 |
| | 100000 | 76 x 146 | 23.4 | 12.60 | 5 | 5 | 28104 | 68104 |
| 100 | 2200 | 35 x 60 | 5.2 | 0.44 | 50 | 29 | 19222 | 59222 |
| | 3300 | 35 x 60 | 6.0 | 0.66 | 42 | 27 | 19332 | 59332 |
| | 3300 | 35 x 80 | 6.6 | 0.66 | 35 | 21 | 29332 | 69332 |
| | 4700 | 35 x 80 | 7.3 | 0.94 | 31 | 20 | 19472 | 59472 |
| | 4700 | 35 x 105 | 7.9 | 0.94 | 26 | 16 | 29472 | 69472 |
| | 6800 | 35 x 105 | 8.8 | 1.36 | 23 | 15 | 19682 | 59682 |
| | 6800 | 50 x 80 | 10.9 | 1.36 | 19 | 12 | 29682 | 69682 |
| | 10000 | 50 x 80 | 10.5 | 2.00 | 21 | 15 | 19103 | 59103 |
| | 10000 | 50 x 105 | 13.1 | 2.00 | 14 | 9 | 29103 | 69103 |
| | 15000 | 50 x 105 | 12.3 | 3.00 | 16 | 12 | 19153 | 59153 |
| | 22000 | 65 x 105 | 14.8 | 4.40 | 11 | 8 | 19223 | 59223 |
| | 22000 | 76 x 105 | 17.4 | 4.40 | 9 | 6 | 29223 | 69223 |
| | 33000 | 76 x 105 | 19.0 | 6.60 | 8 | 6 | 19333 | 59333 |
| | 33000 | 76 x 146 | 20.7 | 6.60 | 7 | 5 | 29333 | 69333 |
| | 47000 | 76 x 146 | 22.4 | 9.40 | 6 | 5 | 29473 | 69473 |

Table 3

| ELECTRICAL DATA AND ORDERING INFORMATION FOR 102 SERIES | | | | | | | | |
|---|----------------------------------|---|--|----------------------------------|---------------------------|-----------------------------|--|---|
| U _R (V) | C _R 100 Hz (μF) | NOMINAL CASE SIZE ∅ D × L (mm) | I _R 100 Hz 85 °C (A) | I _{L5} 5 min (mA) | ESR max 100 Hz (mΩ) | Z MAX. 20 kHz (mΩ) | HIGH POST M5 DISC | |
| | | | | | | | CATALOG NUMBER ST 2222 102 | CATALOG NUMBER STB 2222 102 |
| 200 | 680 | 35 x 60 | 3.5 | 0.27 | 207 | 136 | 12681 | 52681 |
| | 1000 | 35 x 80 | 4.4 | 0.40 | 144 | 95 | 12102 | 52102 |
| | 1000 | 35 x 105 | 4.7 | 0.40 | 140 | 91 | 22102 | 62102 |
| | 1500 | 35 x 105 | 5.5 | 0.60 | 100 | 67 | 12152 | 52152 |
| | 1500 | 50 x 80 | 6.2 | 0.60 | 106 | 74 | 22152 | 62152 |
| | 2200 | 50 x 80 | 8.0 | 0.88 | 67 | 44 | 12222 | 52222 |
| | 3300 | 50 x 80 | 8.9 | 1.32 | 50 | 35 | 12332 | 52332 |
| | 3300 | 50 x 105 | 9.9 | 1.32 | 46 | 32 | 22332 | 62332 |
| | 4700 | 65 x 105 | 12.5 | 1.88 | 37 | 26 | 22472 | 62472 |
| | 6800 | 65 x 105 | 15.2 | 2.72 | 25 | 18 | 12682 | 52682 |
| | 6800 | 76 x 105 | 16.9 | 2.72 | 25 | 18 | 22682 | 62682 |
| | 10000 | 76 x 105 | 19.9 | 4.00 | 18 | 13 | 12103 | 52103 |
| | 10000 | 76 x 146 | 20.4 | 4.00 | 18 | 13 | 22103 | 62103 |
| | 15000 | 76 x 146 | 24.1 | 6.00 | 12 | 9 | 12153 | 52153 |
| 250 | 470 | 35 x 60 | 3.1 | 0.24 | 250 | 152 | 13471 | 53471 |
| | 680 | 35 x 80 | 3.8 | 0.34 | 175 | 107 | 13681 | 53681 |
| | 1000 | 35 x 80 | 4.4 | 0.50 | 128 | 82 | 13102 | 53102 |
| | 1000 | 35 x 105 | 4.8 | 0.50 | 122 | 76 | 23102 | 63102 |
| | 1500 | 35 x 105 | 5.4 | 0.75 | 90 | 58 | 13152 | 53152 |
| | 1500 | 50 x 80 | 7.0 | 0.75 | 81 | 50 | 23152 | 63152 |
| | 2200 | 50 x 80 | 8.0 | 1.10 | 60 | 39 | 13222 | 53222 |
| | 2200 | 50 x 105 | 8.7 | 1.10 | 57 | 35 | 23222 | 63222 |
| | 3300 | 50 x 105 | 9.8 | 1.65 | 42 | 28 | 13332 | 53332 |
| | 3300 | 65 x 105 | 11.4 | 1.65 | 42 | 28 | 23332 | 63332 |
| | 4700 | 65 x 105 | 13.8 | 2.35 | 29 | 19 | 13472 | 53472 |
| | 4700 | 76 x 105 | 15.3 | 2.35 | 29 | 19 | 23472 | 63472 |
| | 6800 | 76 x 105 | 18.1 | 3.40 | 21 | 14 | 13682 | 53682 |
| | 6800 | 76 x 146 | 18.6 | 3.40 | 21 | 14 | 23682 | 63682 |
| | 10000 | 76 x 105 | 19.3 | 5.00 | 17 | 12 | 13103 | 53103 |
| | 10000 | 76 x 146 | 22.0 | 5.00 | 15 | 10 | 23103 | 63103 |
| 350 | 330 | 35 x 60 | 2.5 | 0.23 | 435 | 305 | 15331 | 55331 |
| | 470 | 35 x 80 | 3.1 | 0.33 | 308 | 216 | 25471 | 65471 |
| | 680 | 35 x 105 | 3.8 | 0.48 | 216 | 152 | 25681 | 65681 |
| | 1000 | 50 x 80 | 5.6 | 0.70 | 145 | 102 | 25102 | 65102 |
| | 1500 | 50 x 80 | 6.5 | 1.05 | 102 | 74 | 15152 | 55152 |
| | 1500 | 50 x 105 | 7.0 | 1.05 | 99 | 70 | 25152 | 65152 |
| | 2200 | 50 x 105 | 8.0 | 1.54 | 72 | 52 | 15222 | 55222 |
| | 2200 | 65 x 105 | 9.3 | 1.54 | 72 | 52 | 25222 | 65222 |
| | 3300 | 65 x 105 | 11.4 | 2.31 | 48 | 35 | 25332 | 65332 |
| | 4700 | 76 x 105 | 15.0 | 3.29 | 34 | 25 | 15472 | 55472 |
| | 4700 | 76 x 146 | 15.4 | 3.29 | 34 | 25 | 25472 | 65472 |
| | 6800 | 76 x 146 | 18.3 | 4.76 | 24 | 18 | 25682 | 65682 |



Aluminum Capacitors
Power High Ripple Current Screw Terminals

| ELECTRICAL DATA AND ORDERING INFORMATION FOR 102 SERIES | | | | | | | | |
|---|----------------------------------|---|--|----------------------------------|---------------------------|-----------------------------|--|---|
| U _R (V) | C _R 100 Hz (µF) | NOMINAL CASE SIZE ∅ D × L (mm) | I _R 100 Hz 85 °C (A) | I _{L5} 5 min (mA) | ESR max 100 Hz (mΩ) | Z MAX. 20 kHz (mΩ) | HIGH POST M5 DISC | |
| | | | | | | | CATALOG NUMBER ST 2222 102 | CATALOG NUMBER STB 2222 102 |
| 385 | 220 | 35 x 60 | 2.1 | 0.17 | 575 | 380 | 18221 | 58221 |
| | 330 | 35 x 80 | 2.7 | 0.26 | 386 | 257 | 18331 | 58331 |
| | 470 | 35 x 80 | 3.1 | 0.37 | 279 | 188 | 18471 | 58471 |
| | 680 | 35 x 105 | 3.9 | 0.53 | 196 | 133 | 18681 | 58681 |
| | 1000 | 50 x 80 | 5.6 | 0.77 | 132 | 89 | 18102 | 58102 |
| | 1500 | 50 x 105 | 7.1 | 1.16 | 90 | 61 | 18152 | 58152 |
| | 2200 | 65 x 105 | 10.0 | 1.70 | 61 | 42 | 18222 | 58222 |
| | 3300 | 76 x 105 | 13.4 | 2.55 | 42 | 29 | 18332 | 58332 |
| | 4700 | 76 x 105 | 15.0 | 3.62 | 31 | 22 | 18472 | 58472 |
| | 4700 | 76 x 146 | 16.3 | 3.62 | 29 | 20 | 28472 | 68472 |
| | 6800 | 76 x 146 | 18.3 | 5.24 | 22 | 16 | 18682 | 58682 |
| 400 | 220 | 35 x 60 | 2.1 | 0.18 | 557 | 363 | 16221 | 56221 |
| | 330 | 35 x 60 | 2.5 | 0.26 | 383 | 254 | 16331 | 56331 |
| | 330 | 35 x 80 | 2.7 | 0.26 | 374 | 245 | 26331 | 66331 |
| | 470 | 35 x 80 | 3.1 | 0.38 | 271 | 180 | 16471 | 56471 |
| | 470 | 35 x 105 | 3.3 | 0.38 | 265 | 175 | 26471 | 66471 |
| | 680 | 35 x 105 | 3.9 | 0.55 | 191 | 128 | 16681 | 56681 |
| | 680 | 50 x 80 | 4.5 | 0.54 | 199 | 136 | 26681 | 66681 |
| | 1000 | 50 x 80 | 5.7 | 0.80 | 128 | 86 | 16102 | 56102 |
| | 1000 | 50 x 105 | 6.0 | 0.80 | 125 | 83 | 26102 | 66102 |
| | 1500 | 50 x 105 | 7.1 | 1.20 | 88 | 59 | 26152 | 66152 |
| | 2200 | 65 x 105 | 10.0 | 1.76 | 60 | 40 | 26222 | 66222 |
| | 3300 | 65 x 105 | 12.1 | 2.64 | 40 | 27 | 16332 | 56332 |
| | 3300 | 76 x 105 | 13.4 | 2.64 | 40 | 27 | 26332 | 66332 |
| | 4700 | 76 x 105 | 15.0 | 3.76 | 31 | 21 | 16472 | 56472 |
| | 4700 | 76 x 146 | 16.4 | 3.76 | 28 | 19 | 26472 | 66472 |
| | 6800 | 76 x 146 | 18.3 | 5.44 | 22 | 15 | 26682 | 66682 |
| | 450 | 220 | 35 x 60 | 2.1 | 0.20 | 503 | 313 | 17221 |
| 330 | | 35 x 80 | 2.7 | 0.30 | 339 | 212 | 27331 | 67331 |
| 470 | | 35 x 105 | 3.4 | 0.42 | 241 | 151 | 27471 | 67471 |
| 680 | | 50 x 80 | 4.9 | 0.61 | 159 | 98 | 27681 | 67681 |
| 1000 | | 50 x 80 | 5.7 | 0.90 | 118 | 75 | 17102 | 57102 |
| 1000 | | 50 x 105 | 6.1 | 0.90 | 114 | 72 | 27102 | 67102 |
| 1500 | | 50 x 105 | 7.1 | 1.35 | 81 | 52 | 17152 | 57152 |
| 1500 | | 65 x 105 | 8.3 | 1.35 | 81 | 52 | 27152 | 67152 |
| 2200 | | 65 x 105 | 10.1 | 1.98 | 55 | 35 | 17222 | 57222 |
| 2200 | | 76 x 105 | 11.2 | 1.98 | 55 | 35 | 27222 | 67222 |
| 3300 | | 76 x 105 | 13.5 | 2.97 | 37 | 24 | 17332 | 57332 |
| 3300 | | 76 x 146 | 13.9 | 2.97 | 37 | 24 | 27332 | 67332 |
| 4700 | | 76 x 146 | 16.4 | 4.23 | 26 | 17 | 17472 | 57472 |
| 5600 | | 76 x 146 | 17.3 | 5.04 | 23 | 15 | 17562 | 57562 |



| ADDITIONAL ELECTRICAL DATA | | |
|------------------------------------|--------------------------------------|------------------------------------|
| PARAMETER | CONDITIONS | VALUE |
| Voltage | | |
| Surge voltage | ≤ 250 V versions | $U_s = 1.15 \times U_R$ |
| | ≥ 350 V versions | $U_s = 1.1 \times U_R$ |
| Reverse voltage | | $U_{rev} \leq 1 \text{ V}$ |
| Current | | |
| Leakage current in μA | after 1 minute at U_R | $I_{L1} \leq 0.006 C_R \times U_R$ |
| | after 5 minutes at U_R | $I_{L5} \leq 0.002 C_R \times U_R$ |
| Inductance | | |
| Equivalent series inductance (ESL) | case $\varnothing D = 35 \text{ mm}$ | typ. 13 nH |
| | case $\varnothing D = 50 \text{ mm}$ | typ. 16 nH |
| | case $\varnothing D = 65 \text{ mm}$ | typ. 19 nH |
| | case $\varnothing D = 76 \text{ mm}$ | typ. 20 nH |

RIPPLE CURRENT AND USEFUL LIFE

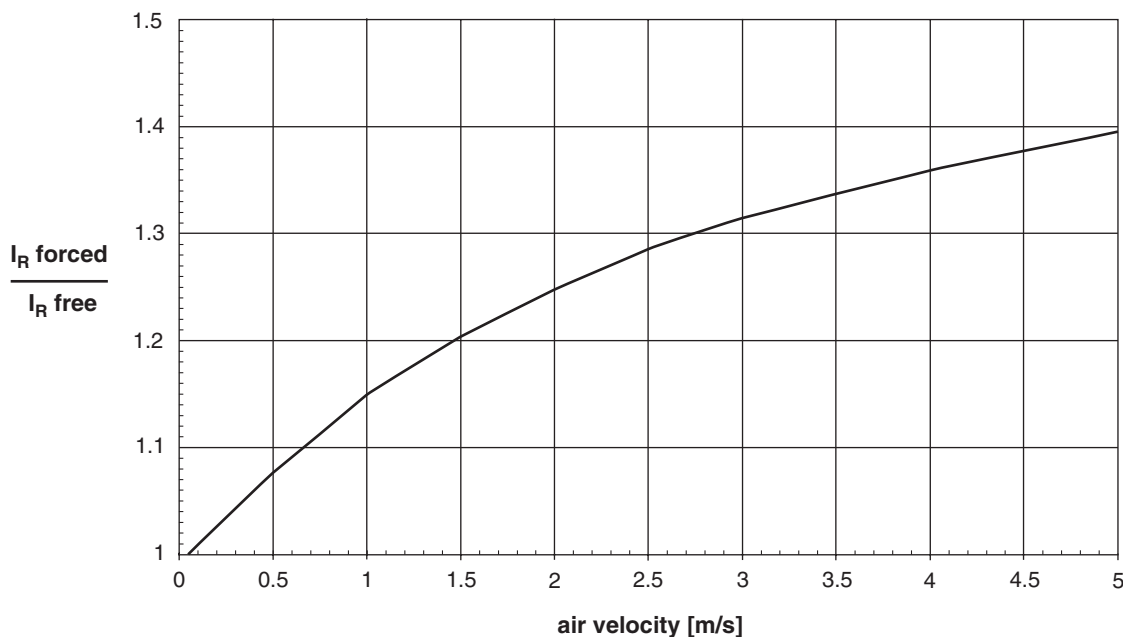

Fig.3 Multiplier of ripple current (I_r) as a function of air flow

| MAXIMUM RIPPLE CURRENT | | | |
|-----------------------------------|-----------|-----------------------------------|-------|
| PARAMETER | CONDITION | MAXIMUM RIPPLE CURRENT MULTIPLIER | VALUE |
| Ambient temperature (T_{amb}) | 70 °C | from nomogram; see fig. 4 | 1.6 |
| Operating frequency (f) | 400 Hz | from frequency ; table 4 | 1.3 |
| Air flow | 2 m/s | from air-flow; see fig. 3 | 1.25 |

Note

Calculation example for 102 series. Maximum ripple current multiplier = 1.6 x 1.3 x 1.25 = 2.6



Aluminum Capacitors
Power High Ripple Current Screw Terminals

Vishay BCcomponents

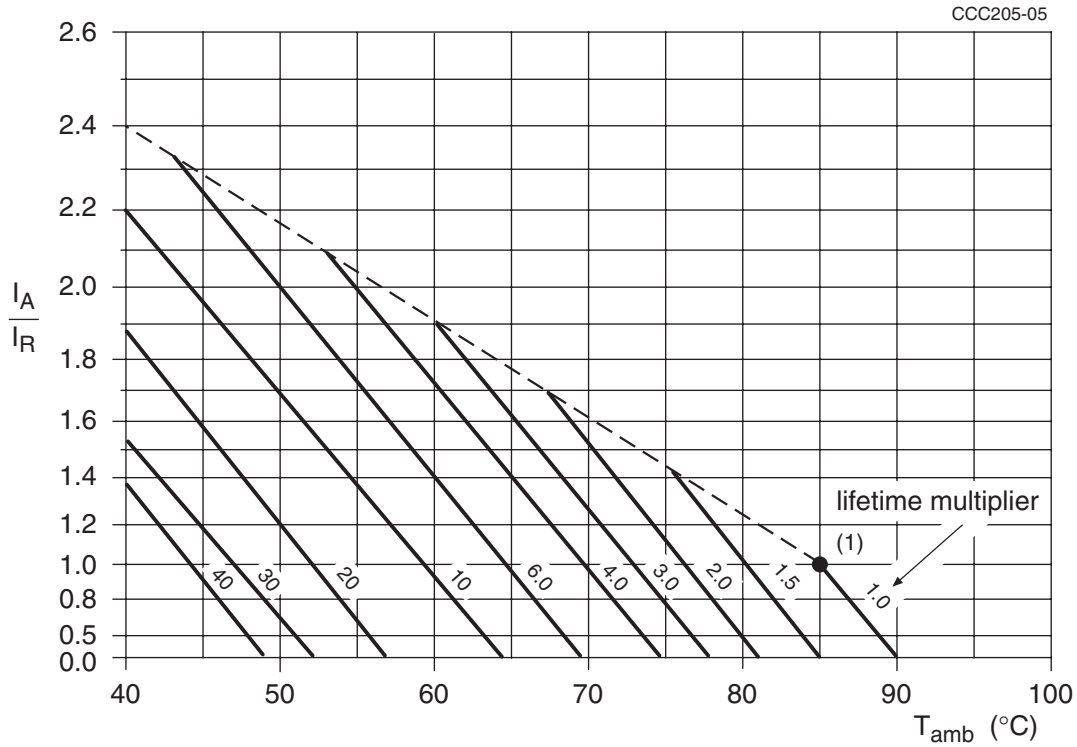

I_A = actual ripple current at 100 Hz
 I_R = rated ripple current at 100 Hz and 85 °C

- (1) Useful life at 85 °C and I_R applied:
101 series: case $\varnothing D \leq 50$: 10000 hours
case $\varnothing D \geq 65$: 15000 hours
102 series: 10000 hours

Fig.4 Multiplier of useful life as a function of ambient temperature and ripple current load

Table 4

| MULTIPLIER OF RIPPLE CURRENT (I_R) AS A FUNCTION OF FREQUENCY | | |
|---|------------------|------|
| FREQUENCY (Hz) | I_R MULTIPLIER | |
| | 101 | 102 |
| 50 | 0.85 | 0.90 |
| 100 | 1.00 | 1.00 |
| 200 | 1.10 | 1.20 |
| 400 | 1.15 | 1.30 |
| 1000 | 1.20 | 1.40 |
| 10000 | 1.30 | 1.50 |

Table 5

| TEST PROCEDURES AND REQUIREMENTS | | | |
|--|--|--|---|
| TEST | | PROCEDURE (quick reference) | REQUIREMENTS |
| NAME OF TEST | REFERENCE | | |
| Endurance | IEC 60384-4/ EN130300 subclause 4.13 | $T_{amb} = 85\text{ }^{\circ}\text{C}$; U_R applied; 2000 hours | $U_R \leq 100\text{ V}$; $\Delta C/C: \pm 15\%$ $U_R > 100\text{ V}$; $\Delta C/C: \pm 10\%$ $\tan \delta \leq 1.3 \times \text{spec. limit}$ $Z \leq 2 \times \text{spec. limit}$ $I_{L5} \leq \text{spec. limit}$ |
| Useful life | CECC 30301 subclause 1.8.1 | $T_{amb} = 85\text{ }^{\circ}\text{C}$; U_R and I_R applied; 101 series: case $\varnothing D \leq 50$:10000 hours case $\varnothing D \geq 65$:15000 hours 102 series: 10000 hours | $U_R \leq 100\text{ V}$; $\Delta C/C: \pm 45\%$ $U_R > 100\text{ V}$; $\Delta C/C: \pm 30\%$ $\tan \delta \leq 3 \times \text{spec. limit}$ $Z \leq 3 \times \text{spec. limit}$ $I_{L5} \leq \text{spec. limit}$ no short or open circuit, no visible damage total failure percentage: $U_R \leq 100\text{ V}: \leq 1\%$; $U_R > 100\text{ V}: \leq 3\%$ |
| Shelf life (storage at high temperature) | IEC 60384-4/ EN130300 subclause 4.17 | $T_{amb} = 85\text{ }^{\circ}\text{C}$; no voltage applied; 500 hours after test: U_R to be applied for 30 minutes, 24 to 48 hours before measurement | $\Delta C/C: \pm 10\%$ $\tan \delta \leq 1.2 \times \text{spec. limit}$ $I_{L5} \leq 2 \times \text{spec. limit}$ |



Notice

Specifications of the products displayed herein are subject to change without notice. Vishay Intertechnology, Inc., or anyone on its behalf, assumes no responsibility or liability for any errors or inaccuracies.

Information contained herein is intended to provide a product description only. No license, express or implied, by estoppel or otherwise, to any intellectual property rights is granted by this document. Except as provided in Vishay's terms and conditions of sale for such products, Vishay assumes no liability whatsoever, and disclaims any express or implied warranty, relating to sale and/or use of Vishay products including liability or warranties relating to fitness for a particular purpose, merchantability, or infringement of any patent, copyright, or other intellectual property right.

The products shown herein are not designed for use in medical, life-saving, or life-sustaining applications. Customers using or selling these products for use in such applications do so at their own risk and agree to fully indemnify Vishay for any damages resulting from such improper use or sale.