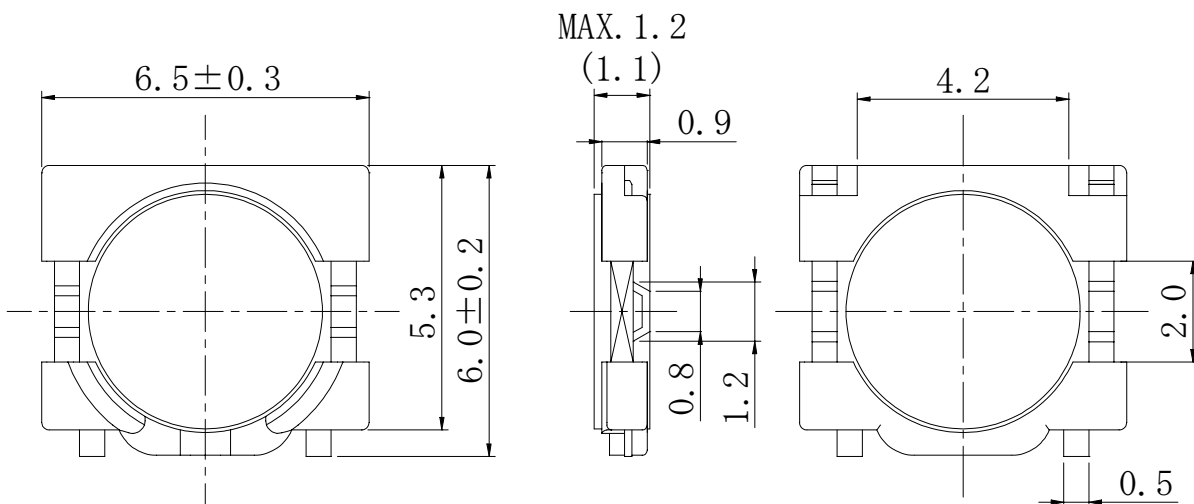
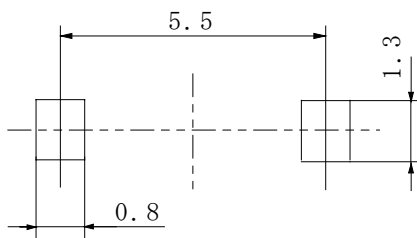

**Type: CR5D11**
**FUJITUS USE ONLY**
**◆ Product Description**

- 6.8×6.2mm Max.(L×W), 1.2mm Max. Height.
- Inductance Range: 1.0~33  $\mu$  H.
- Rated current range:0.4~2.2A.

**◆ Feature**

- Magnetically unshielded construction.
- Ideally used in Mobilephone,PDA,MP3,DSC/DVC,HDD, Notebook PC etc as DC-DC Converter inductors.
- RoHS Compliance

**◆ Dimensions (mm)**

**◆ Land Pattern (mm)**

**Type: CR5D11**
**FUJITUS USE ONLY**
**◆ Specification**

Part Name	Stamp	Inductance [Within] (at 100kHz)	D.C.R.(mΩ) Max.(Typ.) (at 20°C)	Saturation Current (mA) (at 20°C)※1	Temperature Rise current (mA) ※2
CR5D11NP-1R0M□	1R0	1.0 μH ±25%	40(32)	2200	2800
CR5D11NP-1R5M□	1R5	1.5 μH ±25%	50(40)	1900	2500
CR5D11NP-2R0M□	2R0	2.0 μH ±25%	57(45)	1700	2200
CR5D11NP-2R5M□	2R5	2.5 μH ±25%	66(53)	1550	2000
CR5D11NP-3R0M□	3R0	3.0 μH ±25%	92(73)	1400	1700
CR5D11NP-3R9M□	3R9	3.9 μH ±25%	103(82)	1250	1550
CR5D11NP-4R7M□	4R7	4.7 μH ±25%	118(94)	1200	1400
CR5D11NP-5R6M□	5R6	5.6 μH ±25%	149(124)	1050	1200
CR5D11NP-6R2M□	6R2	6.2 μH ±25%	162(135)	1000	1100
CR5D11NP-7R0M□	7R0	7.0 μH ±25%	184(153)	950	1050
CR5D11NP-8R6M□	8R6	8.6 μH ±25%	220(183)	850	950
CR5D11NP-100M□	100	10 μH ±25%	246(205)	750	900
CR5D11NP-120M□	120	12 μH ±25%	304(253)	700	850
CR5D11NP-150M□	150	15 μH ±25%	353(294)	650	750
CR5D11NP-180M□	180	18 μH ±25%	398(332)	600	650
CR5D11NP-220M□	220	22 μH ±25%	592(493)	500	550
CR5D11NP-270M□	270	27 μH ±25%	679(566)	450	500
CR5D11NP-330M□	330	33 μH ±25%	784(653)	400	450

**※ Description of part name**

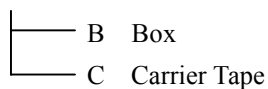
CR5D11NP-1R0M□



※1. Saturation current: The DC current at which the inductance decreases to 80% of it's initial value.

 ※2. Temperature rise current: The DC current at which the temperature rise is  $\Delta t=40^{\circ}\text{C}$ . ( $T_a=20^{\circ}\text{C}$ ).