

Silicon PIN Photodiode KDP6004A

Description

The KDP6004A is high-speed silicon pin photodiode in COB package and responds to wavelengths from 700nm to 1050nm.

Features

- High sensitive Si PIN Photodiode
- Chip on Board Package
- High Speed Response

Applications

- IR Remote Control Module
- High Speed Detector

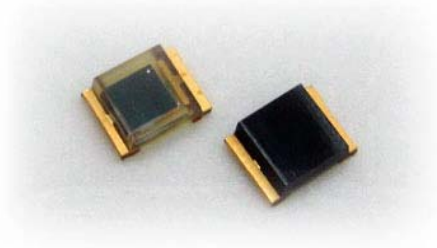

Outline Dimensions

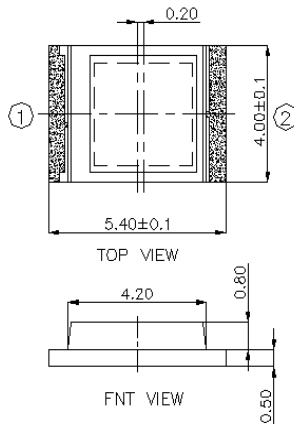

NOTES

1. Pin Description

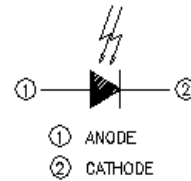

2. General Tolerance

± 0.1mm

3. Unit : mm

Characteristics

[Ta= 25°C]

Description	Symbol	Condition	Min.	Typ.	Max.	Unit
Open Circuit Voltage	V_{OP}	$E_V=1000\text{Lux}^{*1}$	300	380		mV
Short Circuit Current	I_{SC}	$E_V=1000\text{Lux}^{*1}$		90		uA
Reverse Dark Current	I_D	$V_R=10\text{V}, E=0$		2	10	nA
Light Current	I_L	$V_R=5\text{V}, E=1000\text{Lux}$	50			uA
Diode Capacitance	C_D	$V_R=3\text{V}, f=1\text{MHz}, E=0$		25	40	pF
Spectral Sensitivity	λ		700~1050			nm
Peak Wavelength	λ_p			970		nm
Angle of Half Sensitivity	ψ			± 65		deg
Rise Time	t_r	$V_R=10\text{V}, R_L=1\text{k}\Omega$		150		ns
Fall Time	t_f	$V_R=10\text{V}, R_L=1\text{k}\Omega$		150		ns