

VICOR CONFIDENTIAL
 THIS DOCUMENT AND THE DATA DISCLOSED
 HEREIN OR HEREWITH IS NOT TO BE REPRODUCED,
 USED, OR DISCLOSED IN WHOLE OR IN PART
 TO ANYONE WITHOUT PERMISSION OF VICOR CORP.

REV.	DESCRIPTION	DATE	APPROVED
#1	RELEASED FOR DEVELOPMENT	DPK 4/28/97	SWN
#2	REVISED AND REDRAWN	DPK 11/17/97	SWN
#3	ADDED +.010 TO DIM	DPK 12/8/97	SWN
#4	REMOVED P/N STAMPING	DPK 8/24/98	SWN
#5	.40 WAS .400: ADDED '0' TO .100 & .190	DPK 9/10/98	SWN
#6	ADDED NOTE 4, CRITICAL CHA. 'O'	AK 10/7/99	SWN

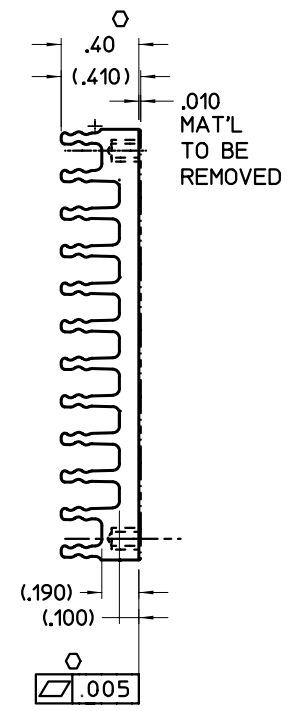
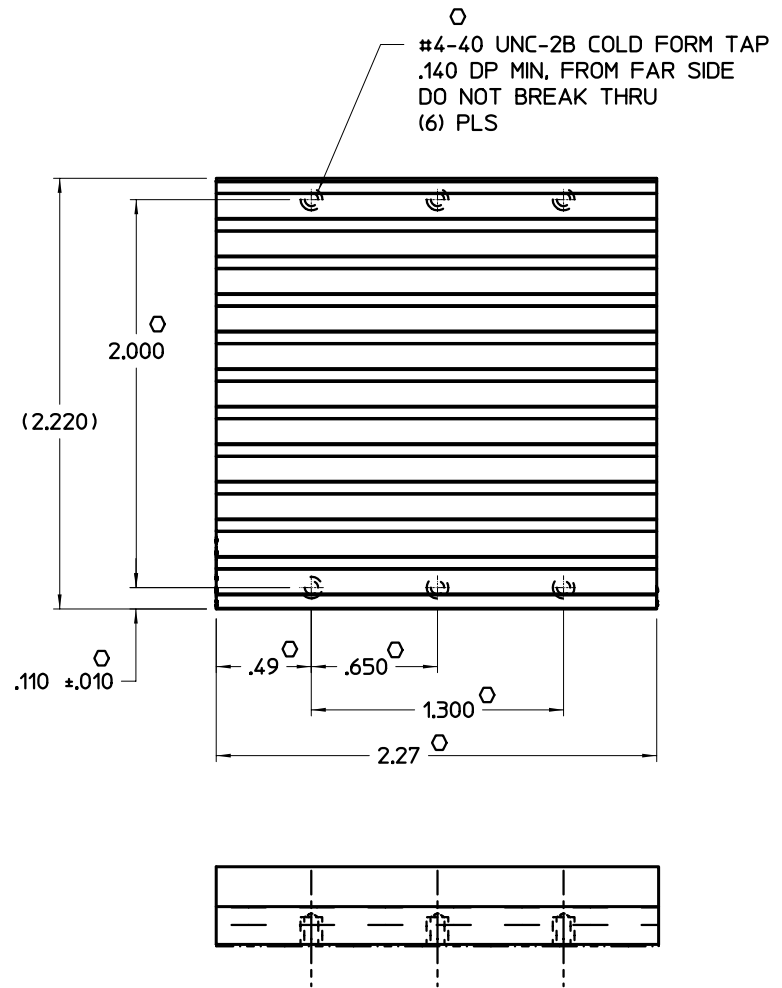

- NOTES
1. MAKE FROM VICOR EXTRUSION P/N 17475.
 2. REMOVE ALL BURRS AND SHARP EDGES.
 3. FINISH: CLEAR CHROMATE.
 4. 'O' DENOTES CRITICAL CHARACTERISTIC FOR LOT INSPECTION.

DRAWN BY D.P. KELLY		DATE 4/97			
<small>UNLESS OTHERWISE SPECIFIED DIMENSIONS ARE IN INCHES - TOLERANCES ARE: FRACTIONS DECIMALS ANGLES #/64 .001 #° .000±.005 #°</small>					
THIRD ANGLE PROJECTION		SIZE B	FSCH NO. 67131	DWG NO. 17485	REV #6
DO NOT SCALE DRAWING		SCALE 2-1	SHEET 1 OF 1		