

**SWITCHMODE SERIES**

**NPN SILICON POWER DARLINGTON TRANSISTORS**

The MJ10002 and MJ10003 darlington transistors are designed for high-voltage, high-speed, power switching in inductive circuits where fall time is critical. They are particularly suited for line operated switch-mode applications such as:

**FEATURES:**

- \*Continuous Collector Current -  $I_C = 10\text{ A}$
- \*Switching Regulators
- \*Inverters
- \*Solenoid and Relay Drivers
- \*Motor Controls

**Boca Semiconductor Corp.**  
<http://www.bocasemi.com>

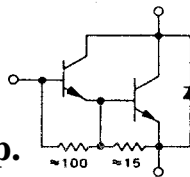

**NPN  
 MJ10002  
 MJ10003**

**10 AMPERE  
 POWER DARLINGTON  
 TRANSISTORS  
 350-400 VOLTS  
 150 WATTS**

**MAXIMUM RATINGS**

Characteristic	Symbol	MJ10002	MJ10003	Unit
Collector-Emitter Voltage	$V_{CEV}$	450	500	V
Collector-Emitter Voltage	$V_{CEX(SUS)}$	400	450	V
Collector-Emitter Voltage	$V_{CEO(SUS)}$	350	400	V
Emitter-Base Voltage	$V_{EBO}$	8.0		V
Collector Current-Continuous	$I_C$	10		A
-Peak	$I_{CM}$	20		
Base current	$I_B$	2.5		A
Total Power Dissipation @ $T_C = 25^\circ\text{C}$	$P_D$	150		W
@ $T_C = 100^\circ\text{C}$		85		W
Derate above $25^\circ\text{C}$		0.86		W/ $^\circ\text{C}$
Operating and Storage Junction Temperature Range	$T_J, T_{STG}$	- 65 to +200		$^\circ\text{C}$

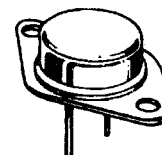

**TO-3**

**THERMAL CHARACTERISTICS**

Characteristic	Symbol	Max	Unit
Thermal Resistance Junction to Case	$R_{\theta jc}$	1.17	$^\circ\text{C}/\text{W}$

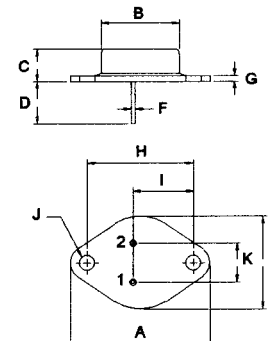

PIN 1.BASE  
 2.EMITTER  
 COLLECTOR(CASE)

DIM	MILLIMETERS	
	MIN	MAX
A	38.75	39.96
B	19.28	22.23
C	7.96	9.28
D	11.18	12.19
E	25.20	26.67
F	0.92	1.09
G	1.38	1.62
H	29.90	30.40
I	16.64	17.30
J	3.88	4.36
K	10.67	11.18

**FIGURE -1 POWER DERATING**

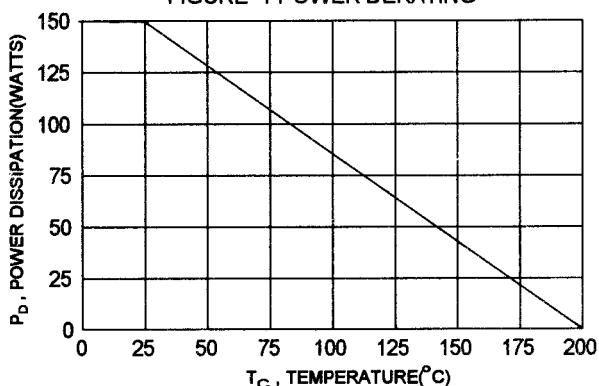

**ELECTRICAL CHARACTERISTICS (  $T_C = 25^\circ\text{C}$  unless otherwise noted )**

Characteristic	Symbol	Min	Max	Unit
----------------	--------	-----	-----	------

**OFF CHARACTERISTICS**

Collector - Emitter Sustaining Voltage ( $I_C = 250\text{ mA}, I_B = 0, V_{\text{clamp}} = \text{Rate } V_{\text{CEO}}$ )	MJ10002 MJ10003	$V_{\text{CEO(sus)}}$	350 400	V
Collector Cutoff Current ( $V_{\text{CE}} = \text{Rated } V_{\text{CEV}}, R_{\text{BE}} = 50\text{ ohm}, T_C = 100^\circ\text{C}$ )		$I_{\text{CER}}$	5.0	mA
Collector Cutoff Current ( $V_{\text{CEV}} = \text{Rated Value}, V_{\text{BE(off)}} = 1.5\text{ V}$ ) ( $V_{\text{CEV}} = \text{Rated Value}, V_{\text{BE(off)}} = 1.5\text{ V}, T_C = 100^\circ\text{C}$ )		$I_{\text{CEV}}$	0.25 5.0	mA
Emitter Cutoff Current ( $V_{\text{EB}} = 8.0\text{ V}, I_C = 0$ )		$I_{\text{EBO}}$	175	mA

**ON CHARACTERISTICS (1)**

DC Current Gain ( $I_C = 2.5\text{ A}, V_{\text{CE}} = 5.0\text{ V}$ ) ( $I_C = 5.0\text{ A}, V_{\text{CE}} = 5.0\text{ V}$ )		hFE	40 30	500 300	
Collector - Emitter Saturation Voltage ( $I_C = 5.0\text{ A}, I_B = 250\text{ mA}$ ) ( $I_C = 10\text{ A}, I_B = 1.0\text{ A}$ ) ( $I_C = 5.0\text{ A}, I_B = 250\text{ mA}, T_C = 100^\circ\text{C}$ )		$V_{\text{CE(sat)}}$		1.9 2.9 2.0	V
Base - Emitter Saturation Voltage ( $I_C = 5.0\text{ A}, I_B = 250\text{ mA}$ ) ( $I_C = 5.0\text{ A}, I_B = 250\text{ mA}, T_C = 100^\circ\text{C}$ )		$V_{\text{BE(sat)}}$		2.5 2.5	V
Diode Forward Voltage ( $I_F = 5.0\text{ A}$ )		$V_F$		5.0	V

**DYNAMIC CHARACTERISTICS**

Small-Signal Current Gain(2) ( $I_C = 1.0\text{ A}, V_{\text{CE}} = 10\text{ V}, f = 1.0\text{ MHz}$ )		$ h_{fe} $	10		
Output Capacitance ( $V_{\text{CB}} = 10\text{ V}, I_E = 0, f = 100\text{ kHz}$ )		$C_{ob}$	60		pF

**SWITCHING CHARACTERISTICS**

Delay Time	$V_{\text{CC}} = 250\text{ V}, I_C = 5.0\text{ A}$ $I_{B1} = 250\text{ mA}, V_{\text{BE(off)}} = 5.0\text{ V}$ $t_p = 50\text{ us}, \text{Duty Cycle} \leq 2\%$	$t_d$	0.2	us
Rise Time		$t_r$	0.6	us
Storage Time		$t_s$	3.0	us
Fall Time		$t_f$	1.5	us

(1) Pulse Test: Pulse width = 300 us , Duty Cycle  $\leq$  2.0%(2)  $f_T = |h_{fe}| \cdot f_{\text{test}}$

DC CURRENT GAIN

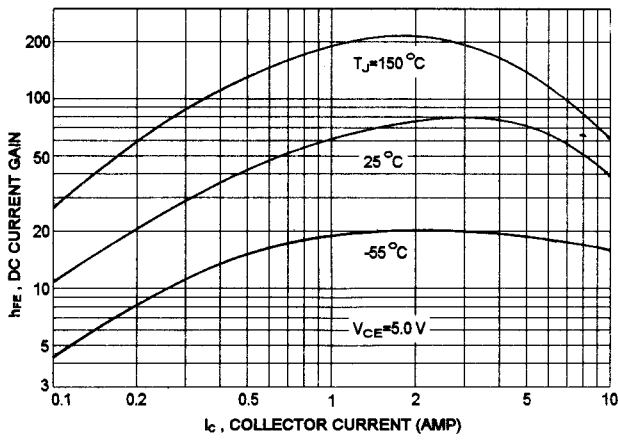

COLLECTOR SATURATION REGION

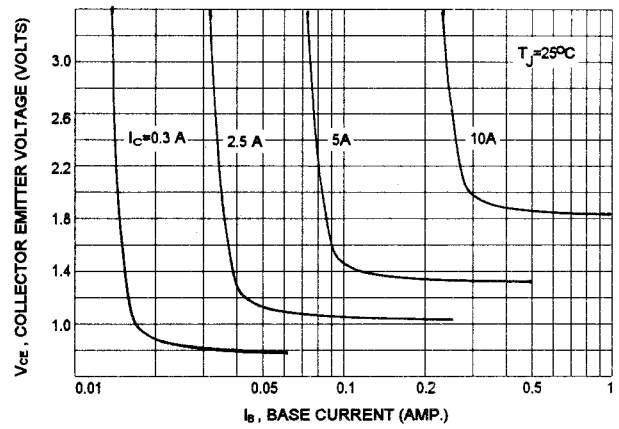

COLLECTOR EMITTER SATURATION VOLTAGE

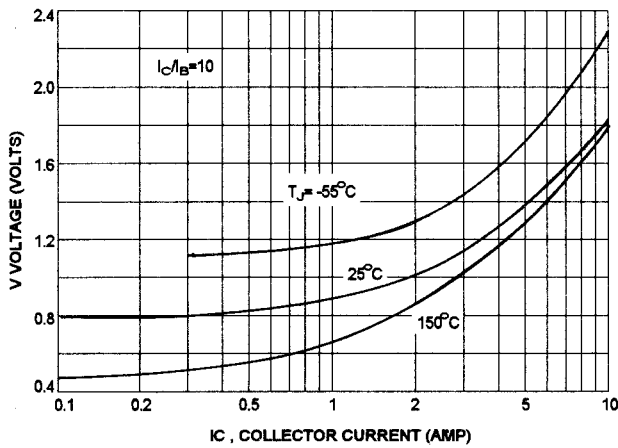

BASE EMITTER VOLTAGE

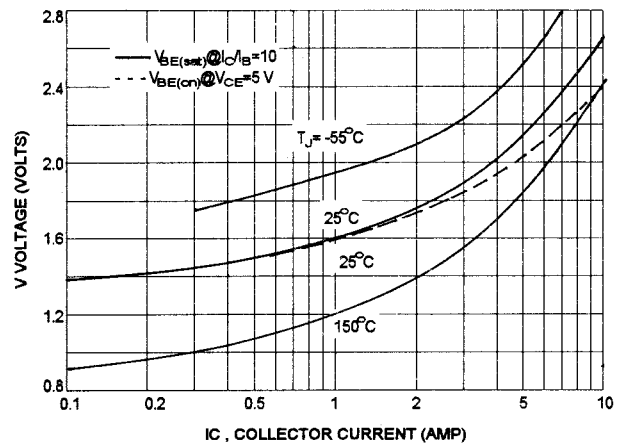

COLLECTOR CUT-OFF REGION

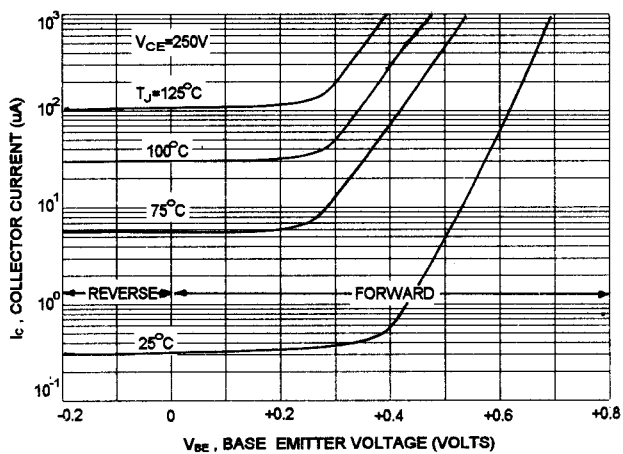

OUTPUT CAPACITANCES

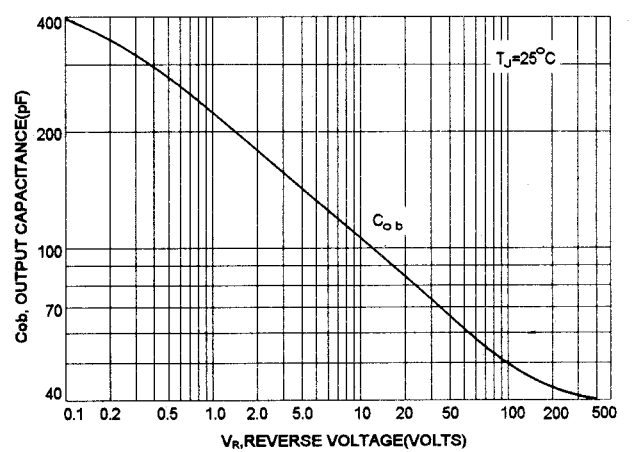

TURN-ON TIME

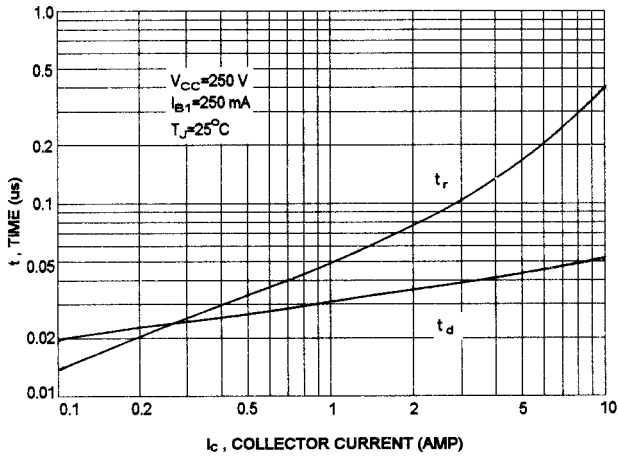

TURN-OFF TIME

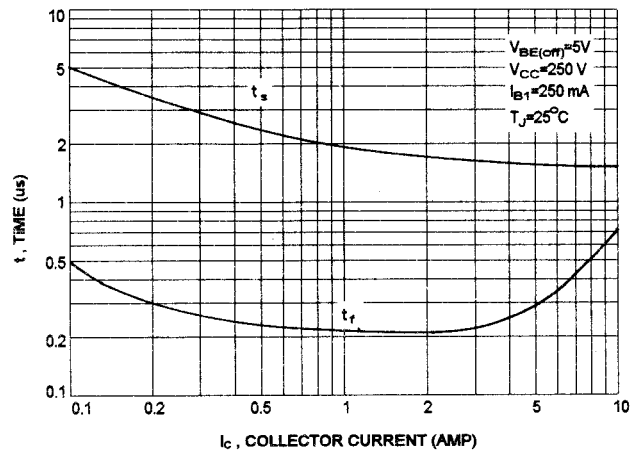

ACTIVE REGION SAFE OPERATING AREA

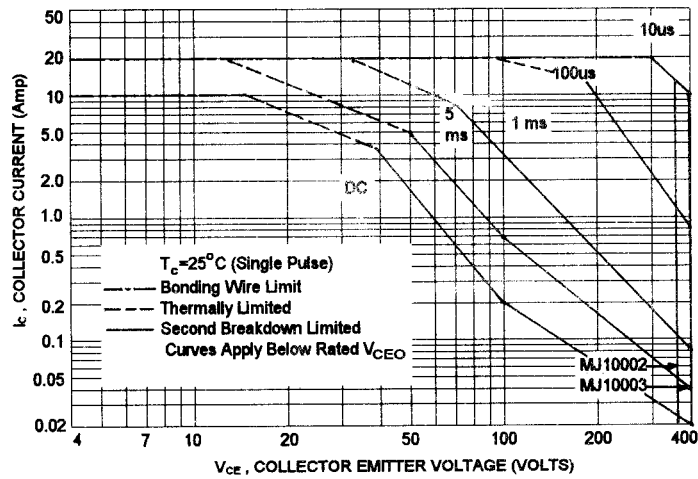

REVERSE BIAS SWITCHING SAFE OPERATING AREA

