

International Power Sources, Inc.

260 Hopping Brook Road
 Holliston, Massachusetts 01746
 Tel. (508) 429-4440 Fax (800) 226-2100
<http://www.intlpower.com>

DC/DC Converters



SHOWN
ACTUAL
SIZE

NMH SERIES 2 WATTS

FEATURES

- 0.23 in² board space
- 80% Efficiency
- 22 Watts per in³
- 5, 12, 24 and 48 VDC Inputs
- SIP and DIL Packages
- 1000 VDC Isolation

MODELS CHART

OUTPUT VOLTAGE(S)	OUTPUT CURRENT(S)	PART NUMBERS			
		5VDC INPUT	12VDC INPUT	24VDC INPUT	48VDC INPUT
±5VDC	±200mA	NMH0505	NMH1205	NMH2405	NMH4805
±9VDC	±110mA	NMH0509	NMH1209	NMH2409	NMH4809
±12VDC	±85mA	NMH0512	NMH1212	NMH2412	NMH4812
±15VDC	±65mA	NMH0515	NMH1215	NMH2415	NMH4815

Add suffix "S" for single-in-line package, suffix "D" for dual-in-line package.

ELECTRICAL SPECIFICATIONS

All specifications typical at nominal line, full load and 25°C

Input voltage range	±10%
Input reflected noise (20MHz BW)	100mV p-p
Output voltage accuracy	±5%
Line regulation	1.2%/1% of Vin
Load regulation (10% to 100% Load)	±10%
Output ripple and noise (20 MHz BW)	150mV p-p max.
Efficiency at full load	75% typical
Total output power (either output)	2 watts
Short circuit protection	short term
Switching frequency	100 KHz
Input output isolation	1000VDC (1000 megohms) min.
Temperature coefficient	0.01% per °C max.
No load power consumption	180mW
Operating temperature range	-50°C to 125°C 0°C to 70°C (no derating)
Storage temperature range	-55°C to 125°C

Specifications subject to change. Unit requires 10mm of air space.

MECHANICAL SPECIFICATIONS

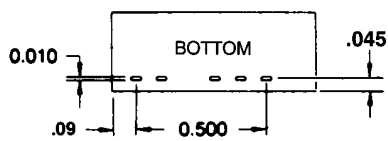
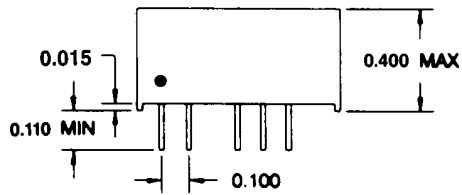
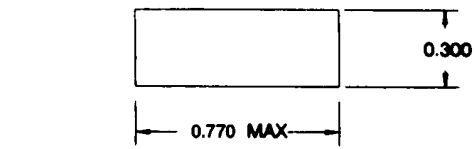

SINGLE-IN-LINE PACKAGE

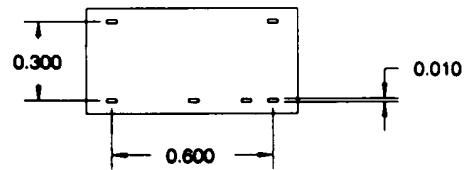
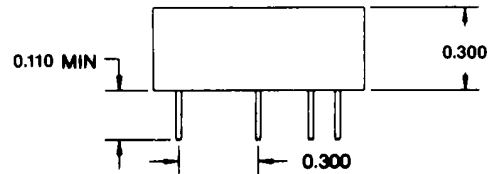
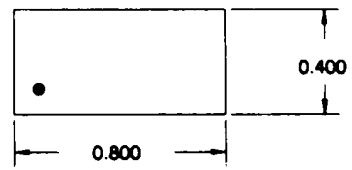

DUAL-IN-LINE PACKAGE

Pins .01 x .02 inches

PIN CONNECTIONS

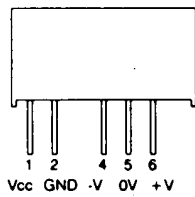

SINGLE-IN-LINE PACKAGE

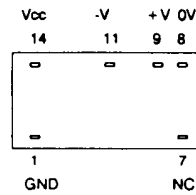

DUAL-IN-LINE PACKAGE (TOP VIEW)

OUTPUT CHARACTERISTICS

